

# 제 5강. 한국 목구조 - 구성부재와 양식

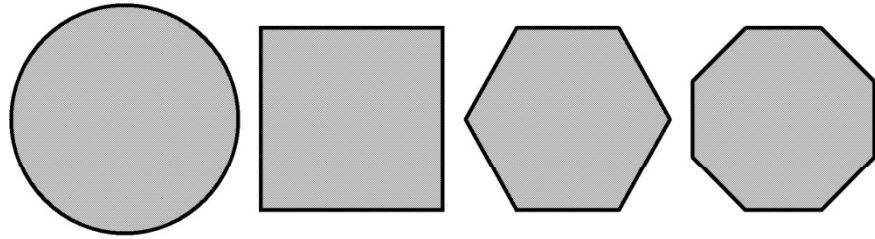

원주

각주

육모주

팔모주

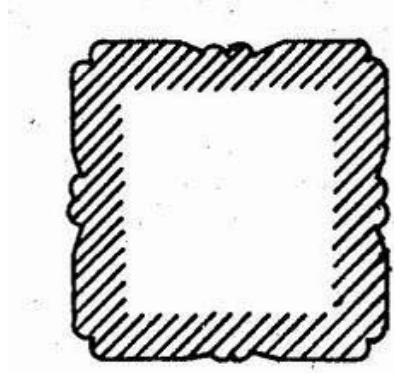
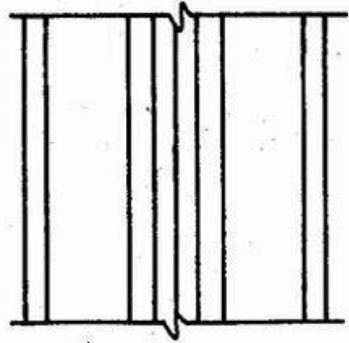

모집기와 쌍사치기

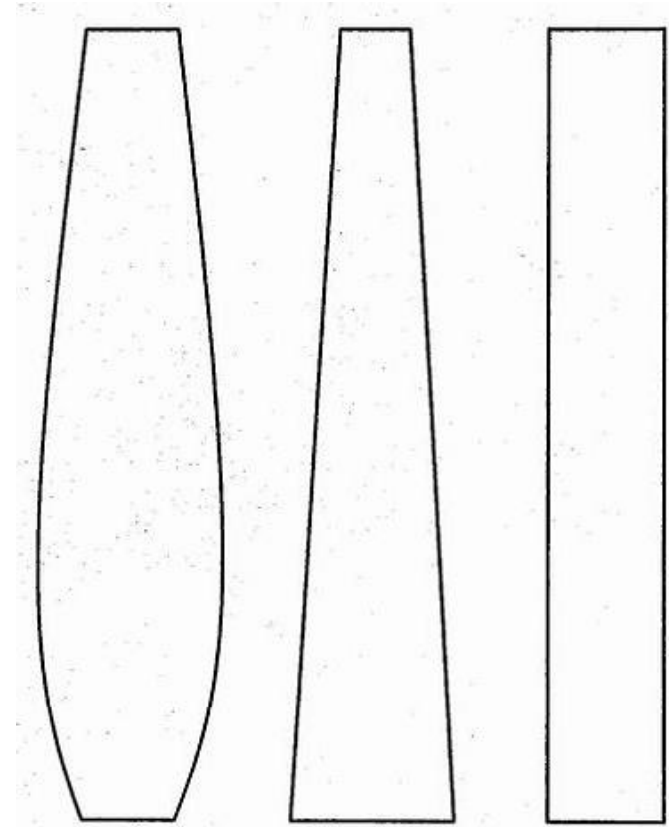

베흘림

민흘림

직립주

기둥

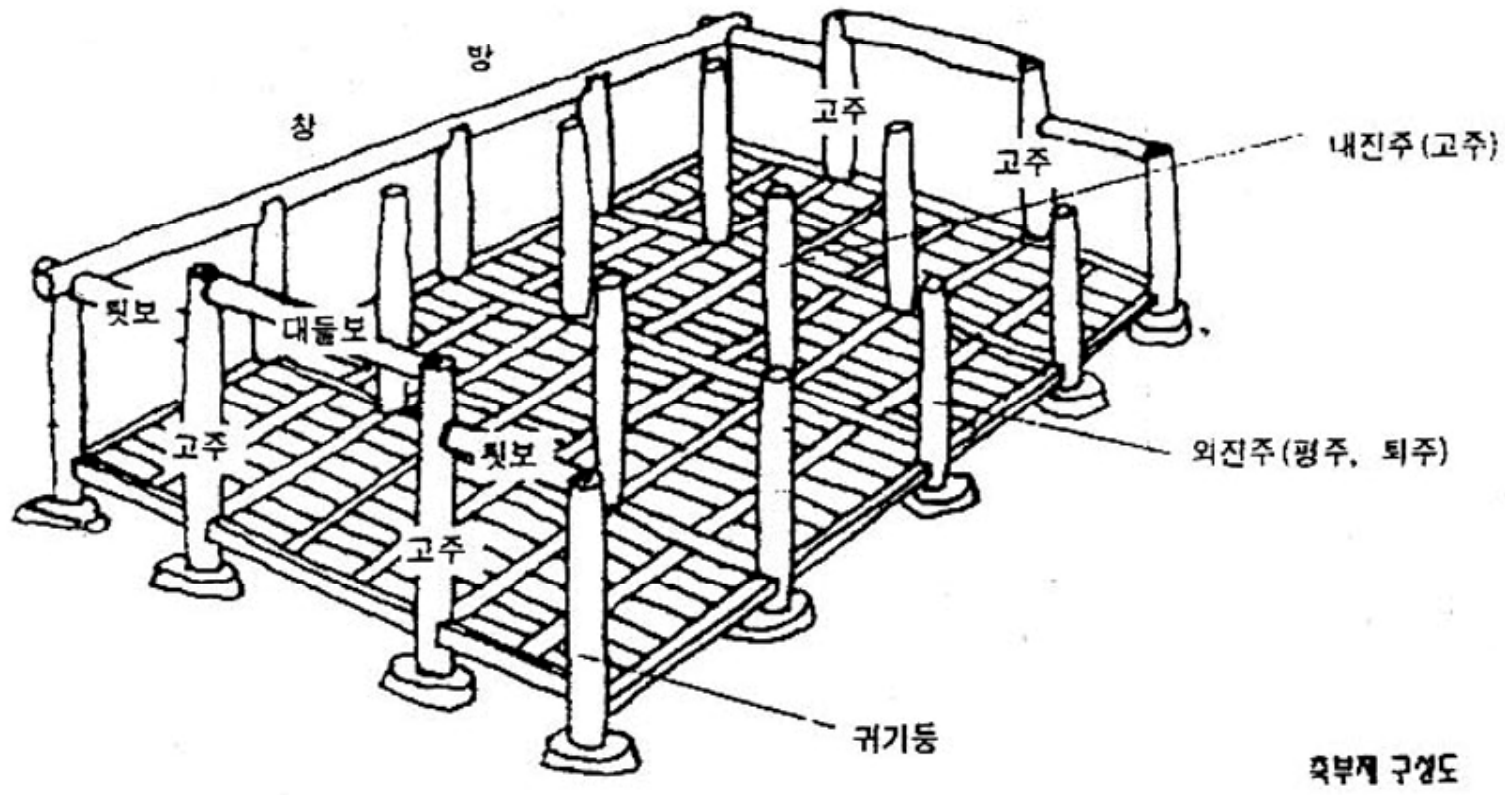

꺾부계 구성도

기둥의 종류  
 < 김동현, 한국 목조건축의 기법 >

외진 평주

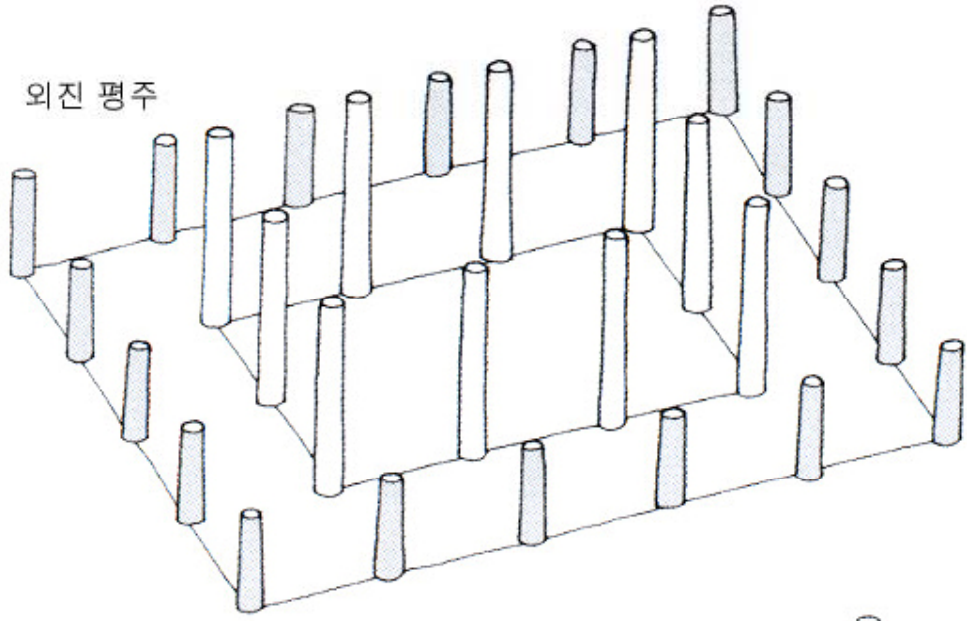

내진 고주

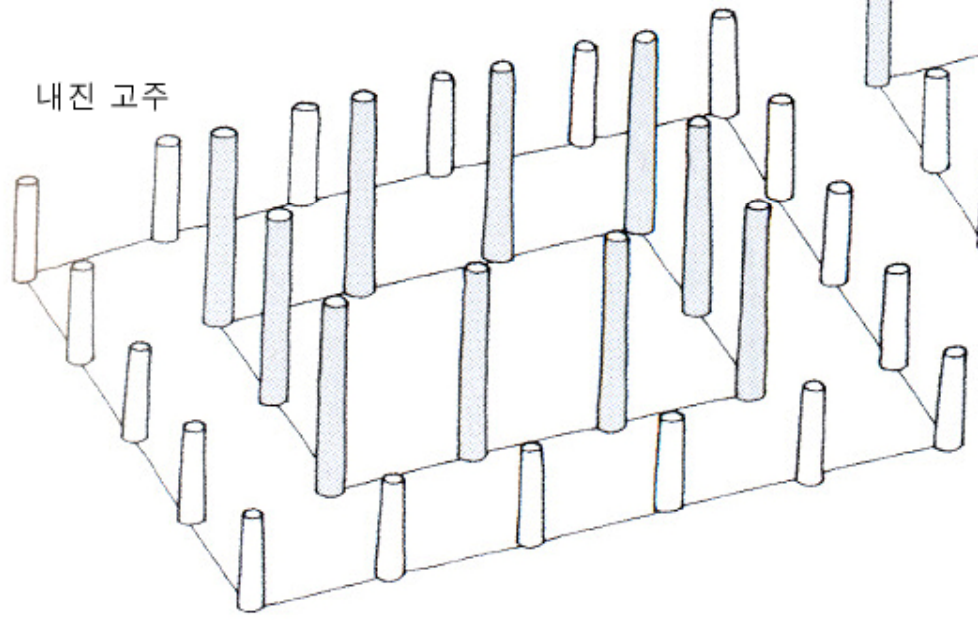

우주

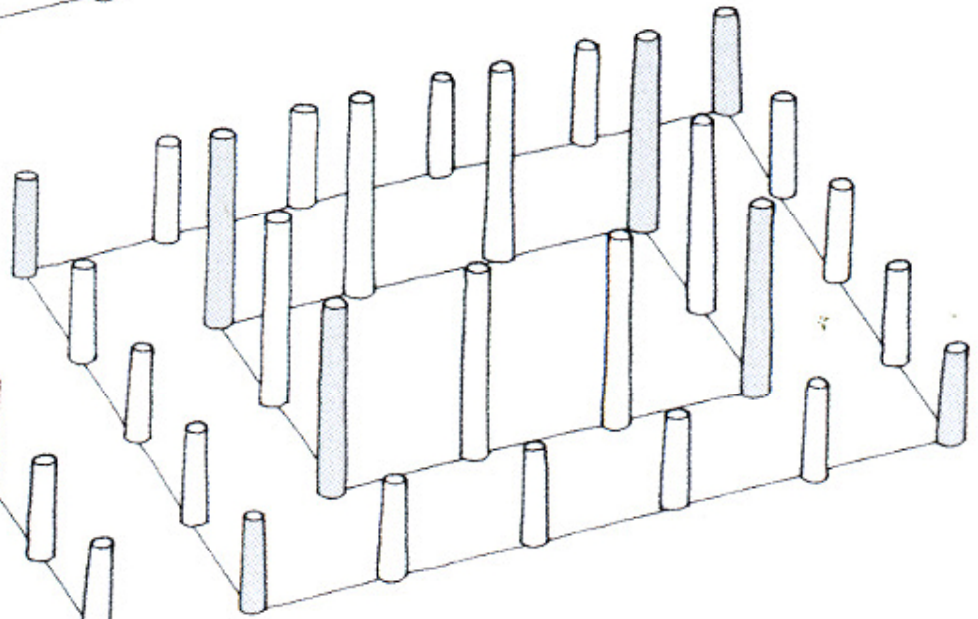

기둥의 종류  
 < 김왕직, 그림으로 보는 한국건축용어 >



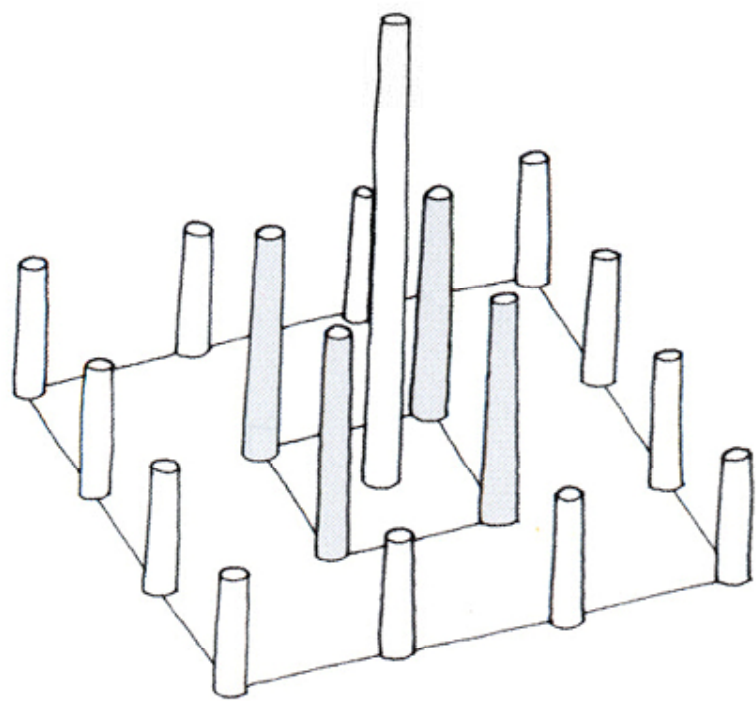

사천주

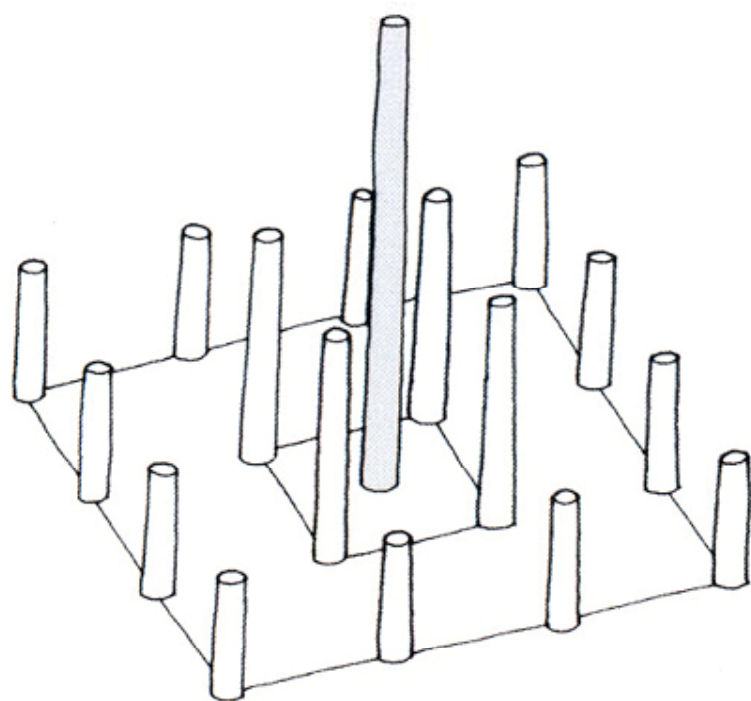

심주

기둥의 종류  
 < 김왕직, 그림으로 보는 한국건축용어 >

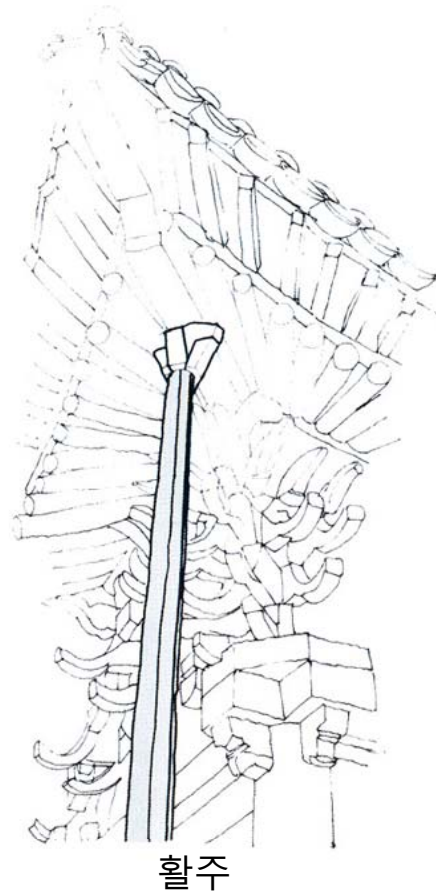
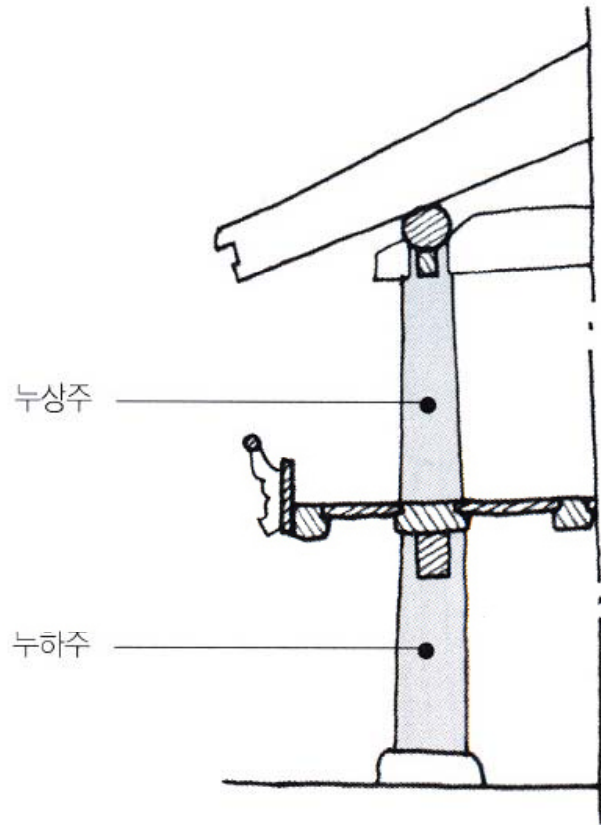

활주(울곡사 대웅전)

기둥의 종류

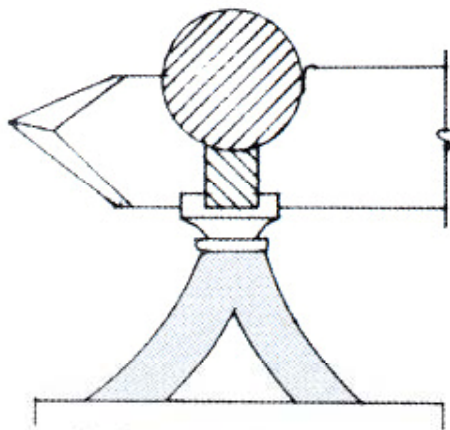

'사'자 동자주

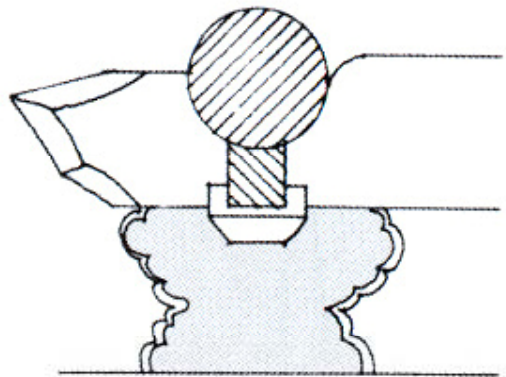

화반 동자주

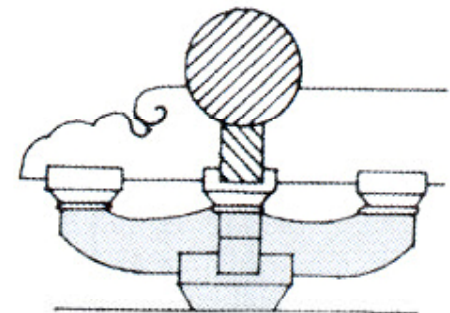

포 동자주

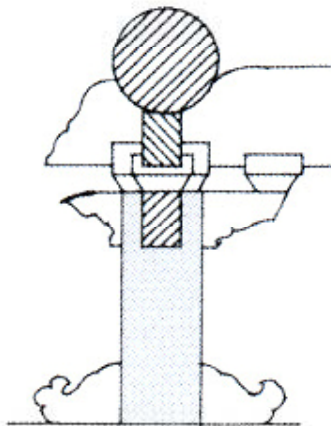

동자형 동자주

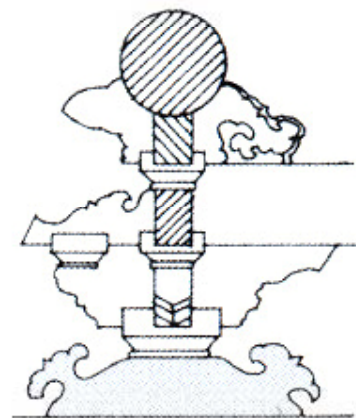

복화반형 동자주

동자주의 종류  
 < 김왕직, 그림으로 보는 한국건축용어 >

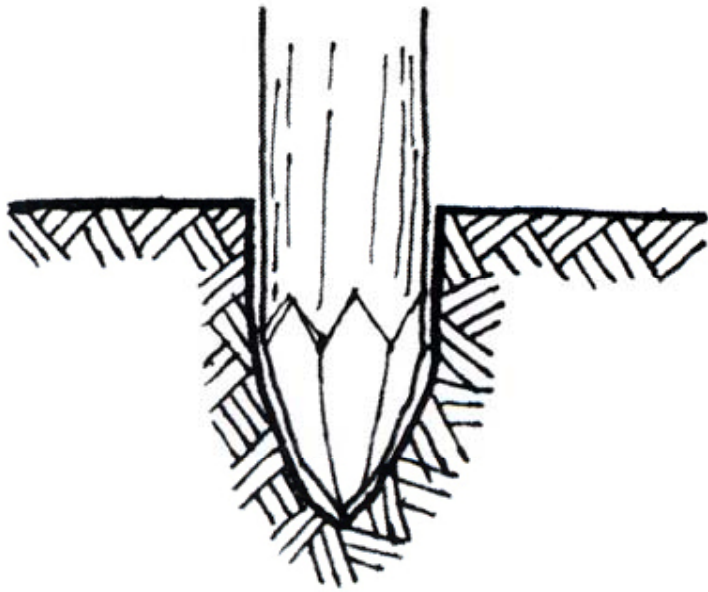

굴립주

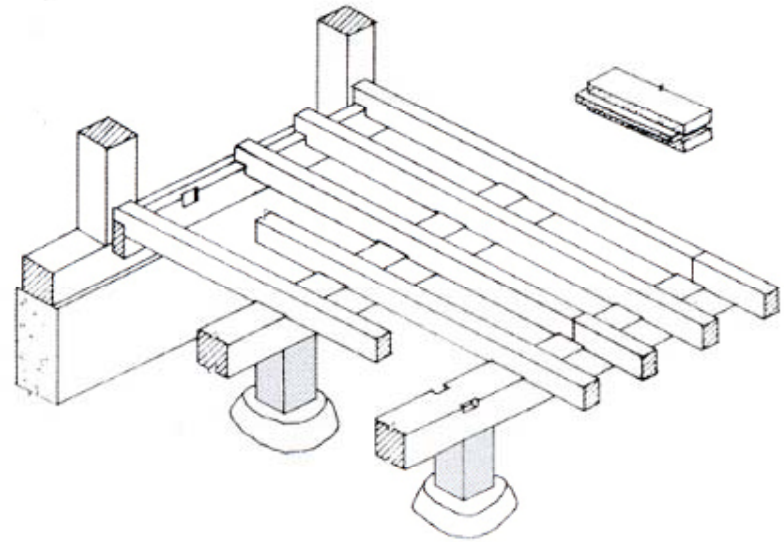

동바리

기둥의 종류  
 < 김왕직, 그림으로 보는 한국건축용어 >



3 량(樑)

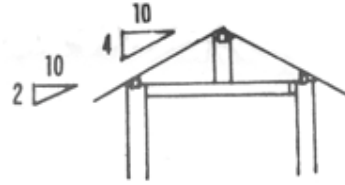

3 량



4 량

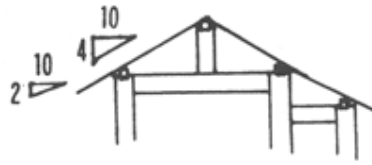

고주(高柱) 4 량

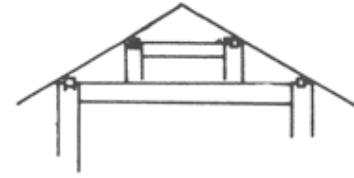

평(平) 4 량



5 량

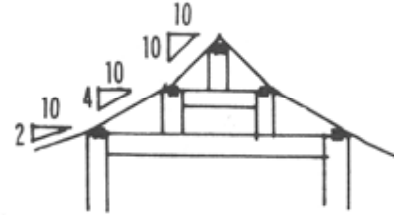

무고주(無高柱) 5 량

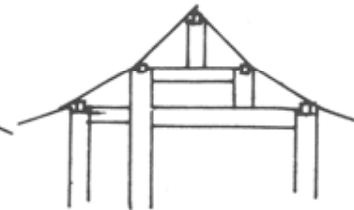

1 고주 5 량

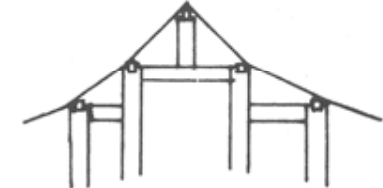

2 고주 5 량



7 량

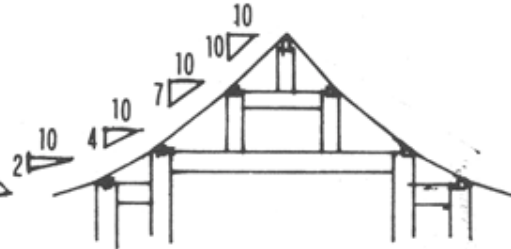

2 고주 7 량

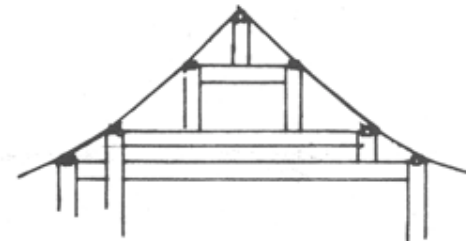

1 고주 7 량

가구형식의 분류



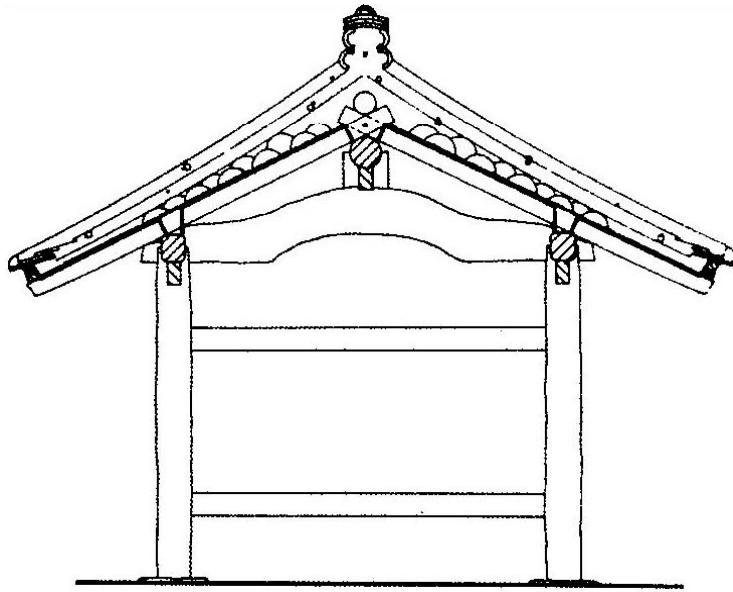

3량가

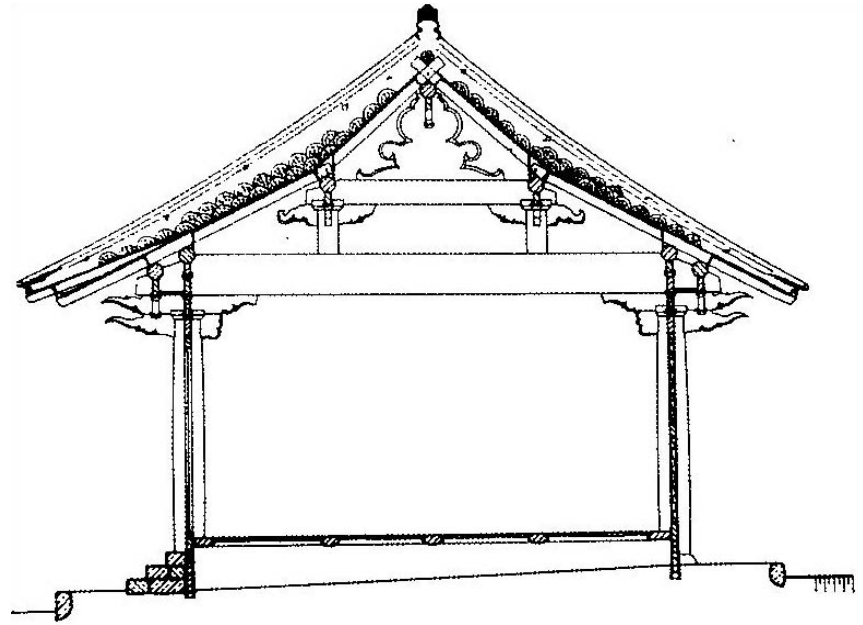

5량가

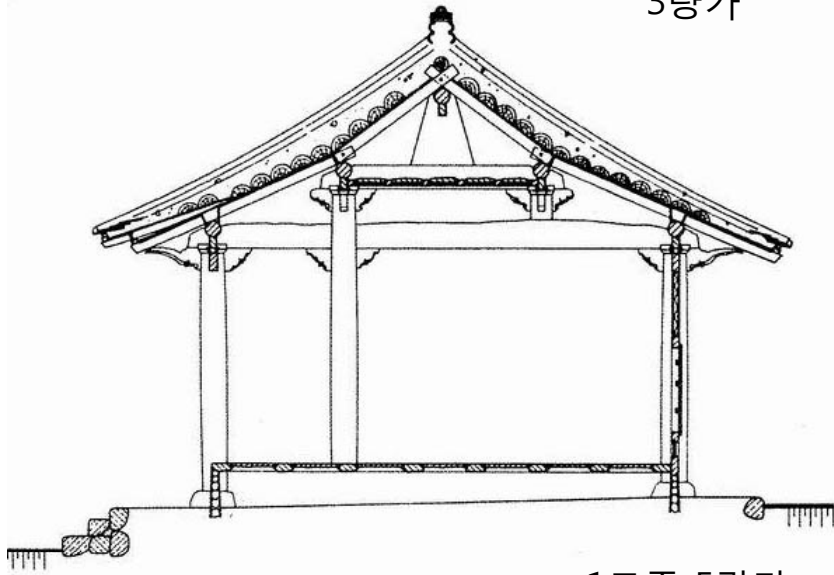

1고주 5량가

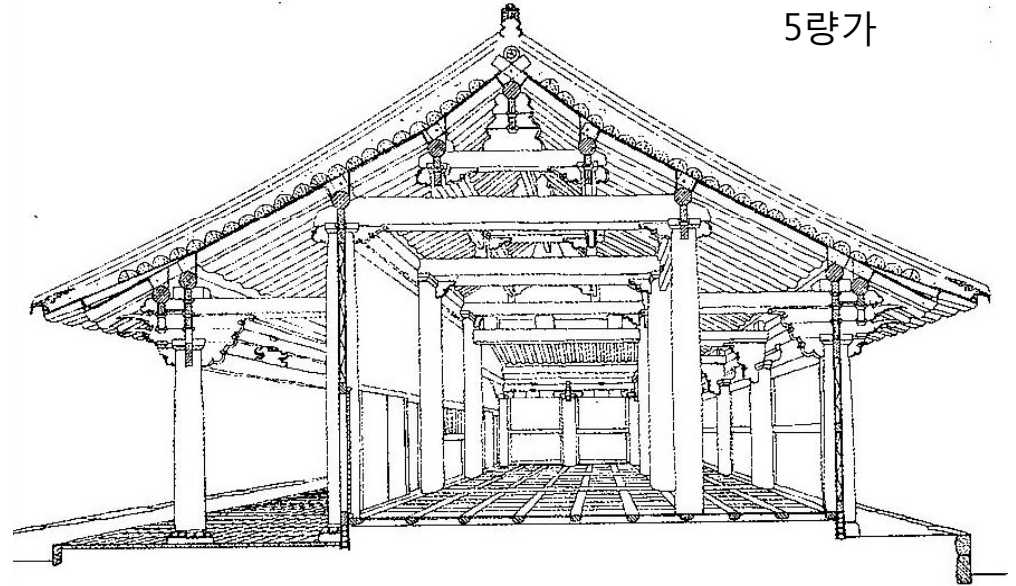

7량가

## 가구 형식의 분류

(김왕직, 그림으로 보는 한국 건축 용어)



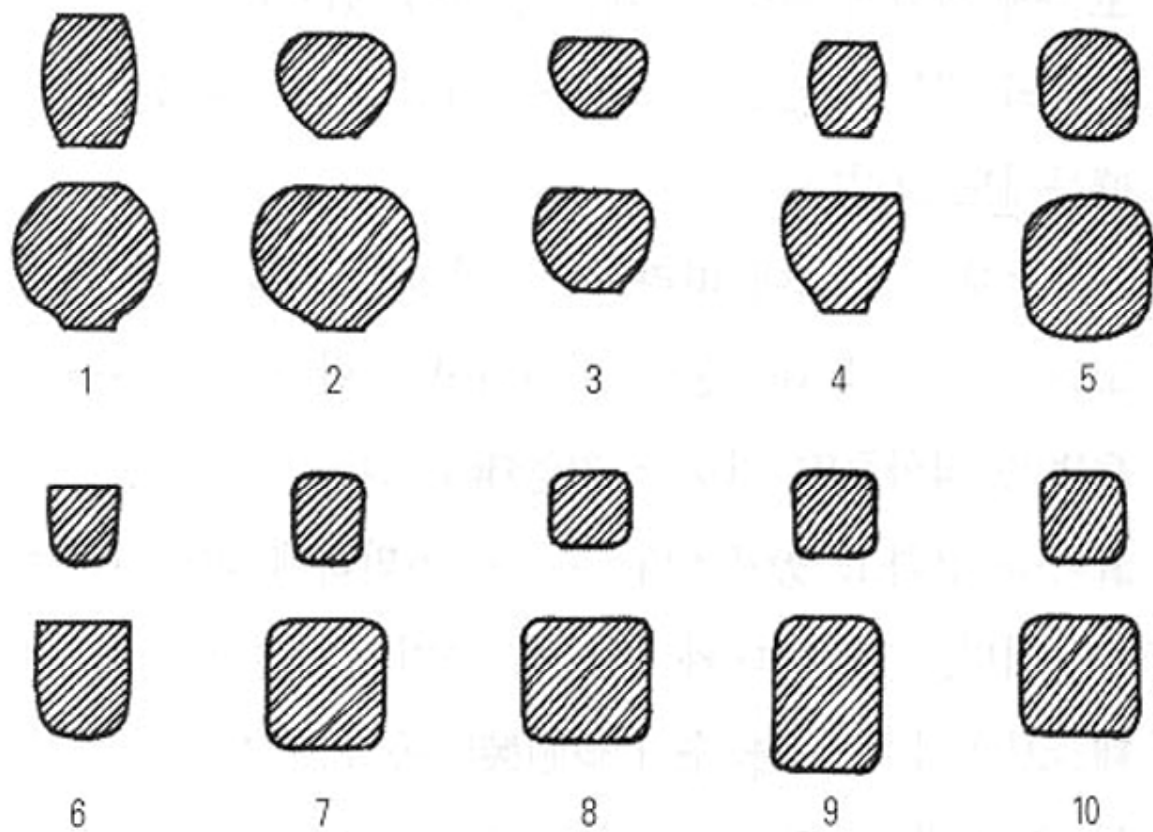

보의 단면

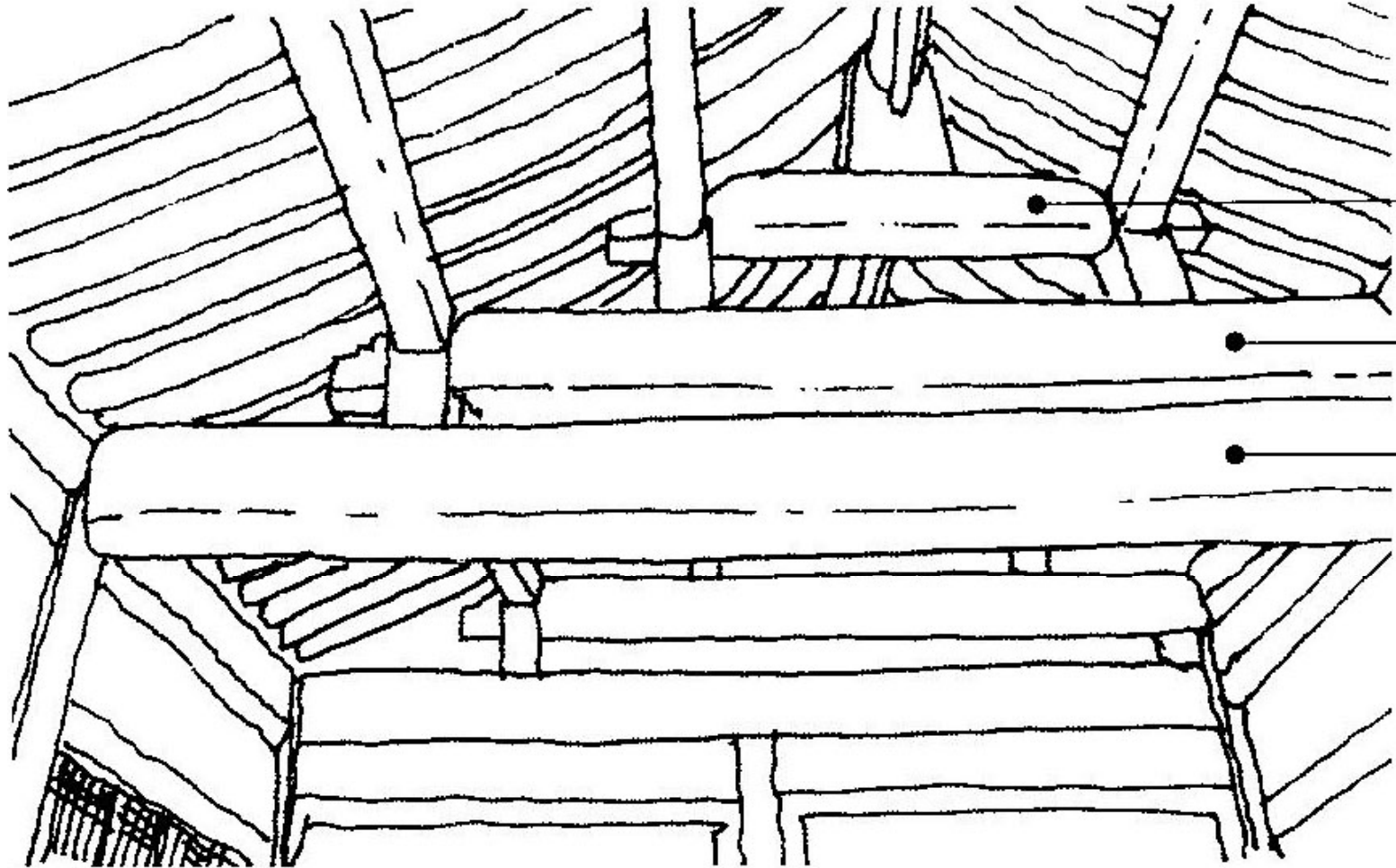

종보

중보

대들보

## 보의 종류

(김왕직, 그림으로 보는 한국 건축 용어)

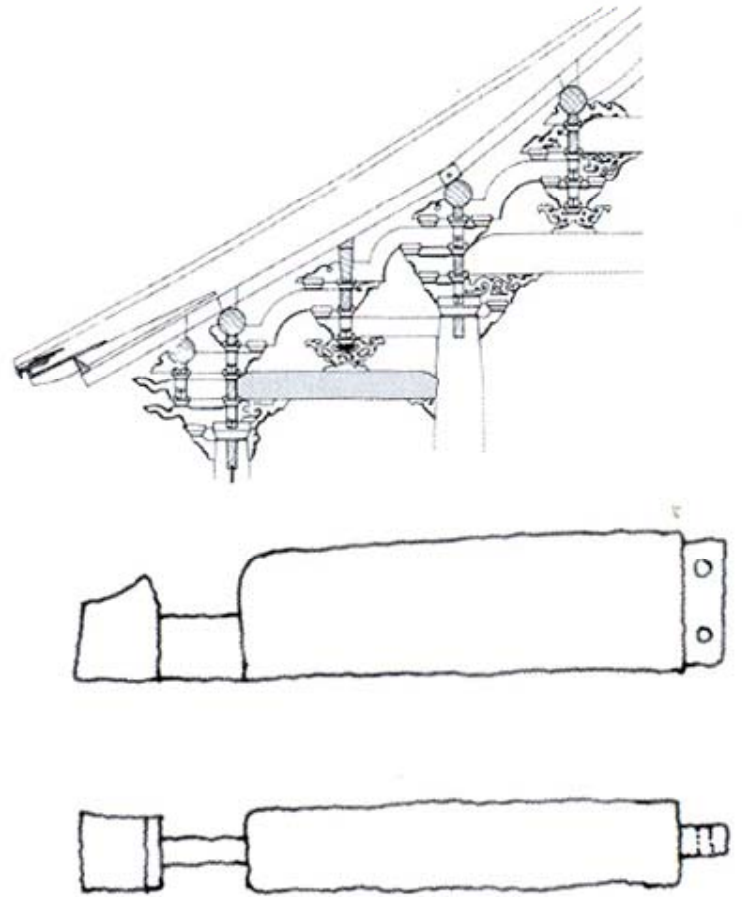
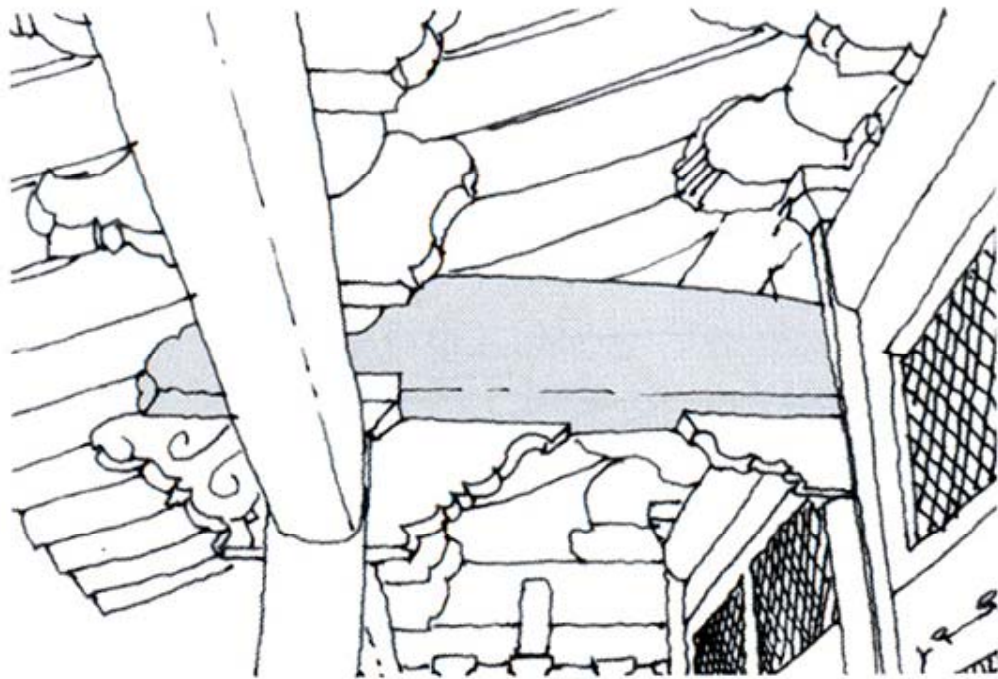

퇴보  
< 김왕직, 그림으로 보는 한국건축용어 >

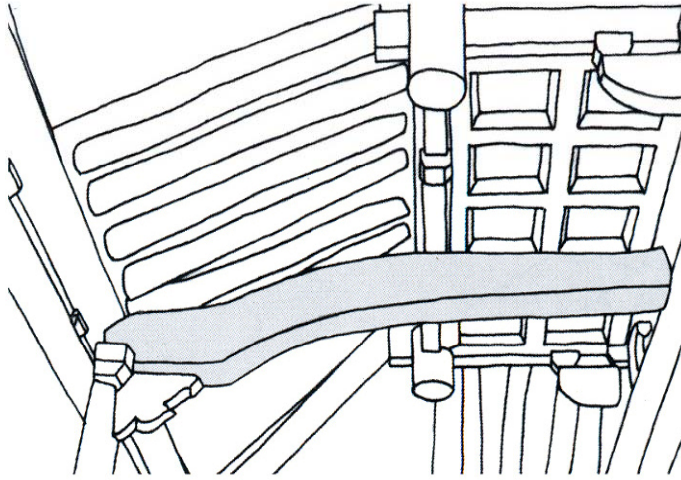

중랑  
〈김홍직, 그림으로 보는 한국건축용어〉

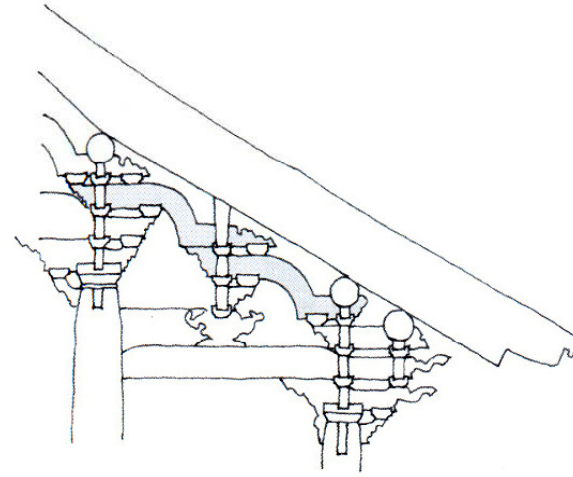

우미랑  
〈김홍직, 그림으로 보는 한국건축용어〉

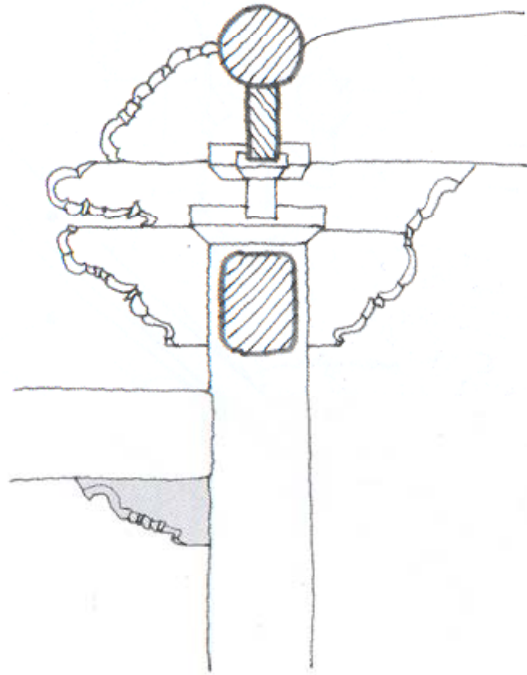

부석사 범종루 보아지  
< 경북 영주시 부석면 >



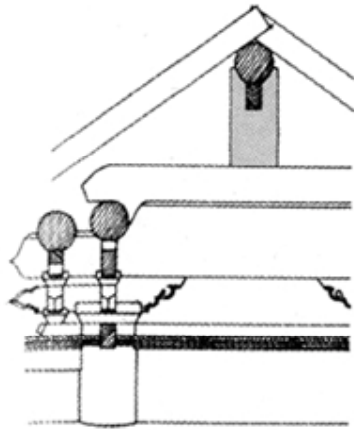

동자대공

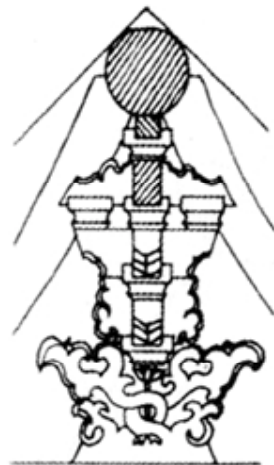

접시대공/포대공

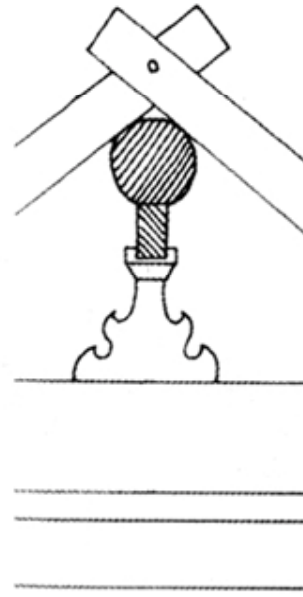

화반대공

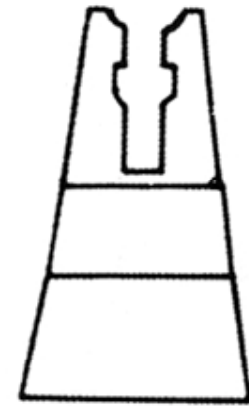

판대공

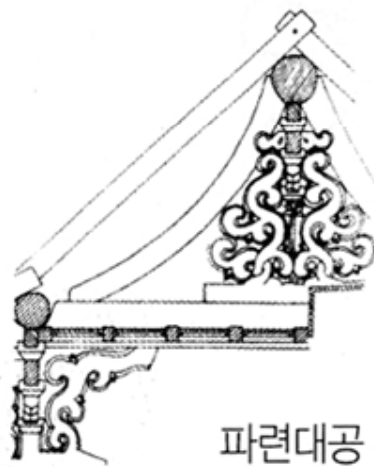

파려대공

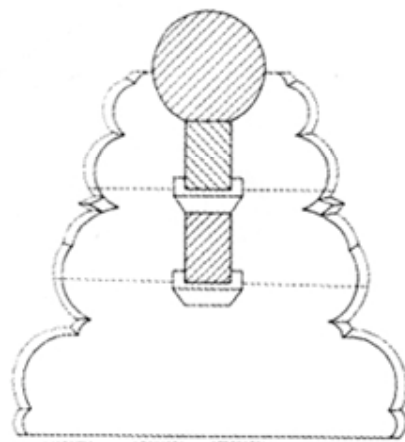

운형대공

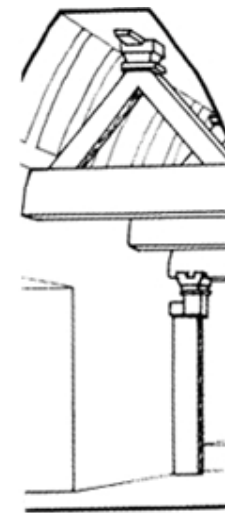

인자대공

대공의 종류



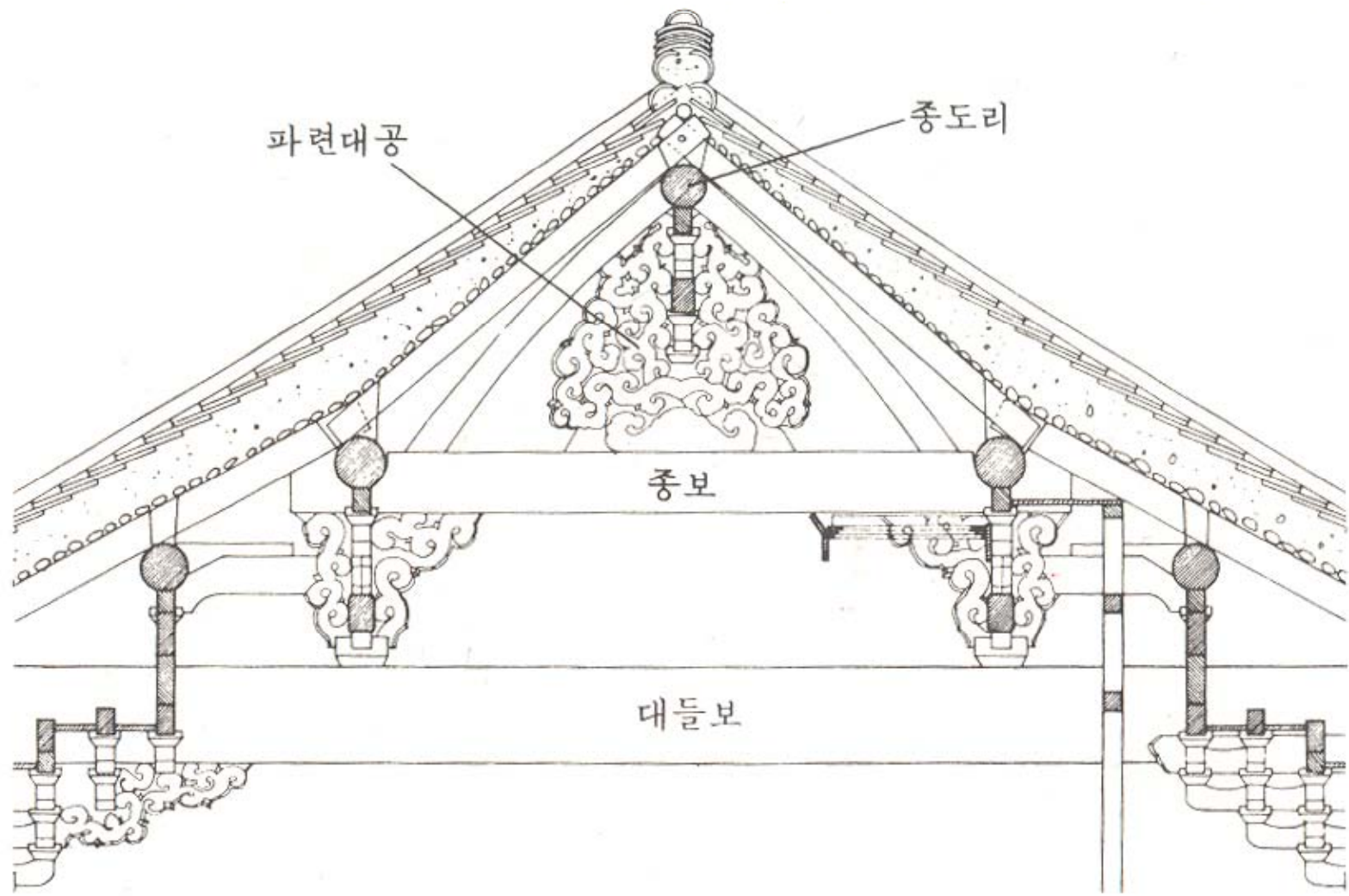

파련 대공

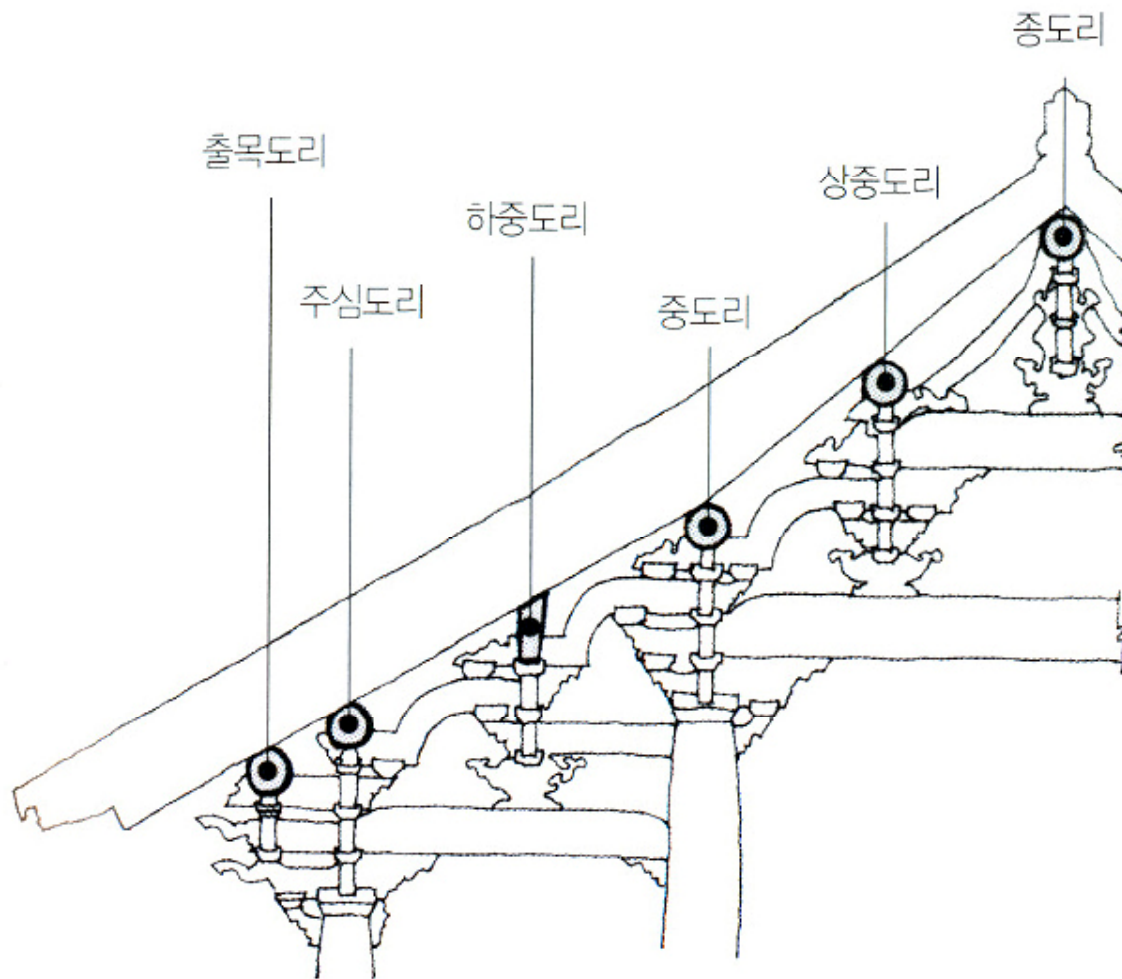

도리의 명칭  
 < 김왕직, 그림으로 보는 한국건축용어 >

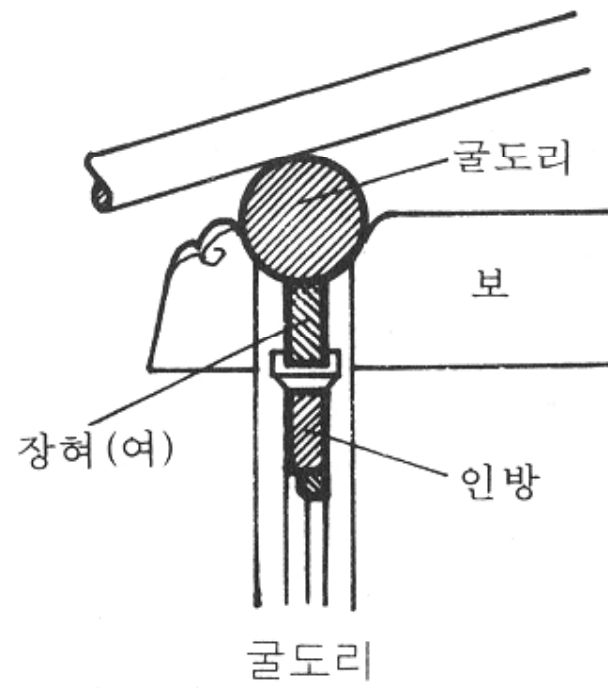
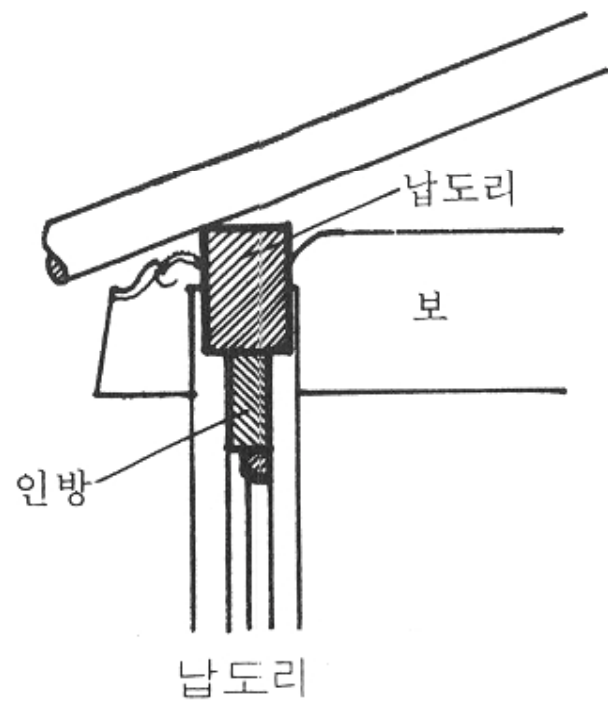

납도리와 굴도리

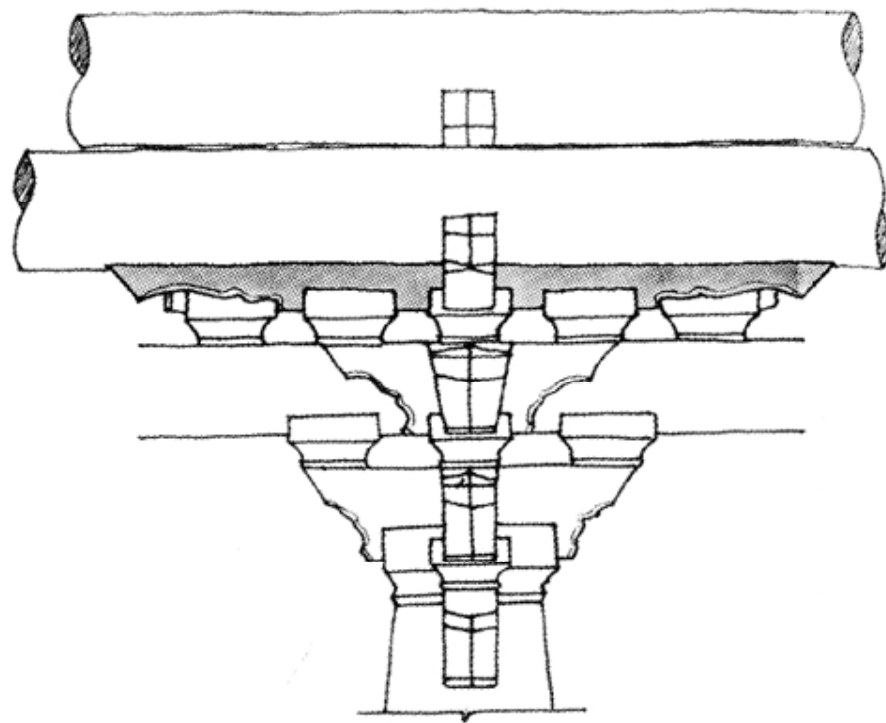
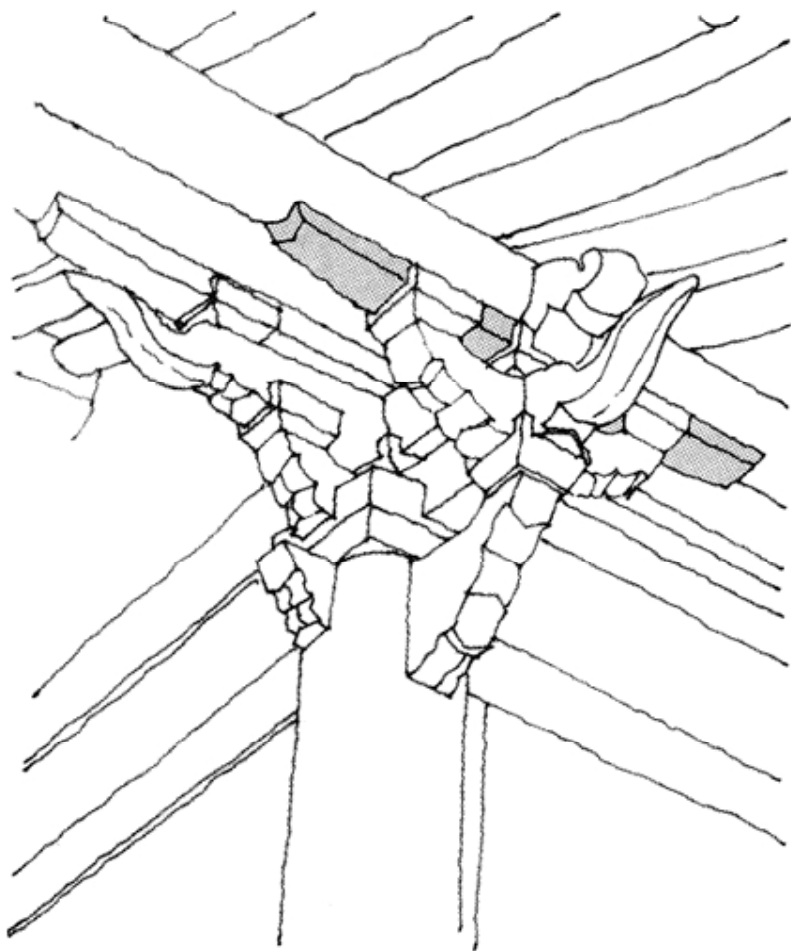

단장혀  
< 김왕직, 그림으로 보는 한국건축용어 >

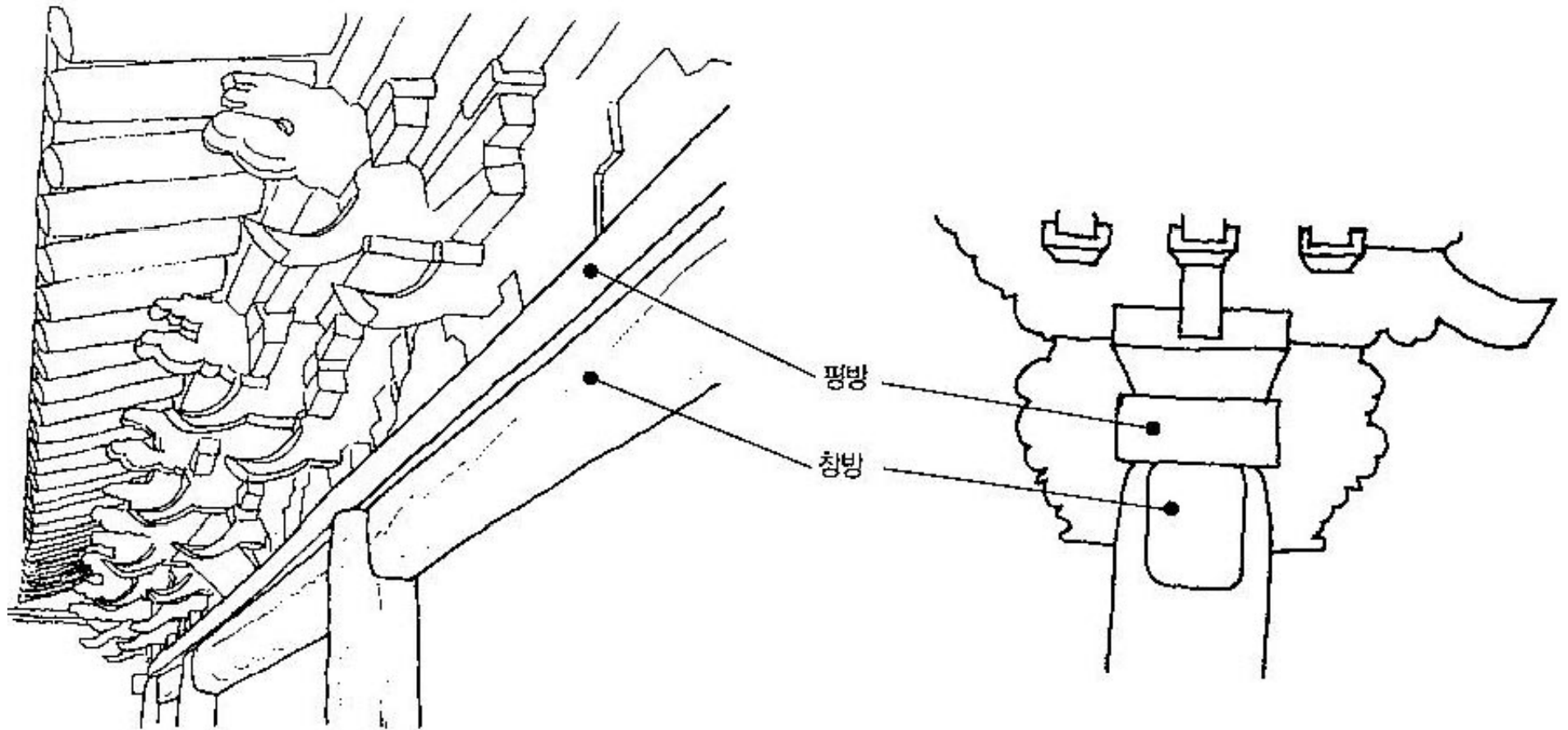

평방

창방

### 평방과 창방

(김왕직, 그림으로 보는 한국 건축 용어)

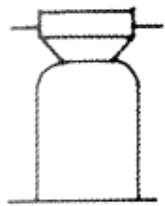
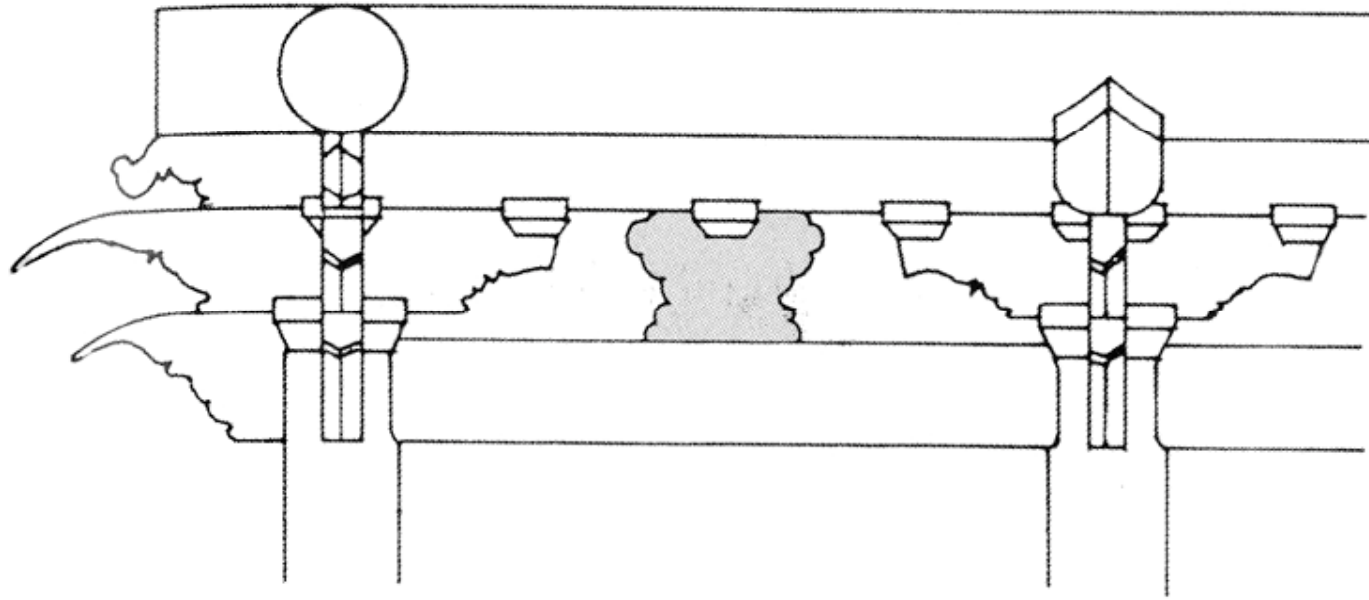

동자형

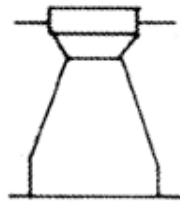

제형

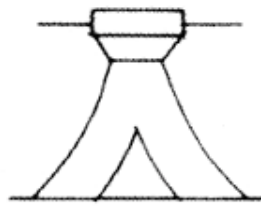

숫을(人자형)

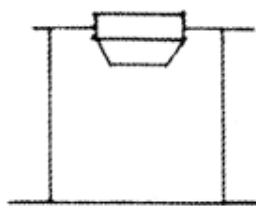

방형

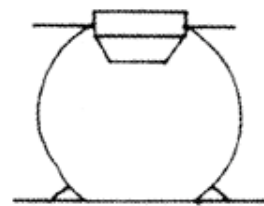

원형

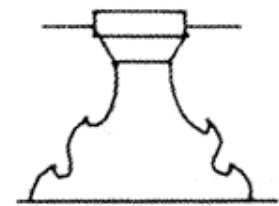

복화반형

화반의 종류  
 < 김왕직, 그림으로 보는 한국건축용어 >



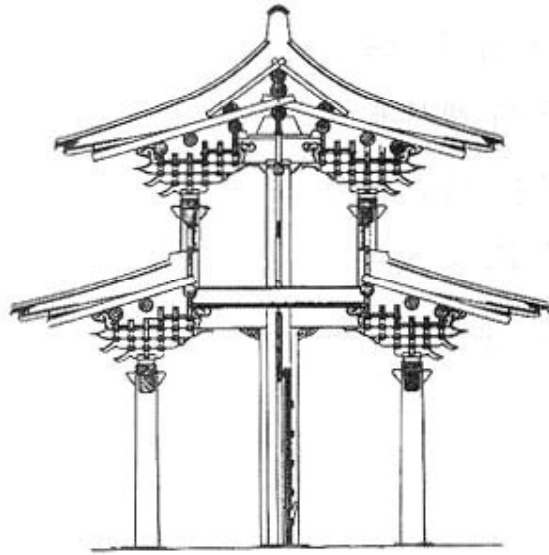

창경궁 홍화문 단면도



제3·48도 전주 풍남문

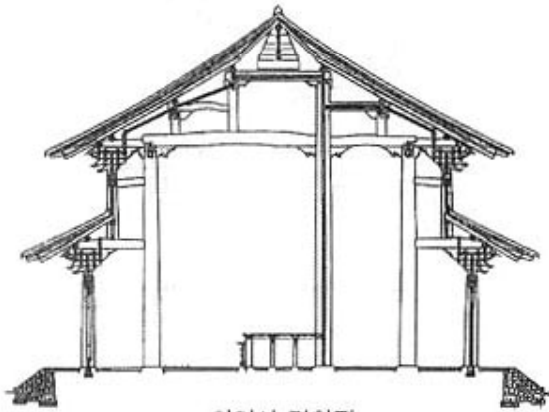

화엄사 각황전

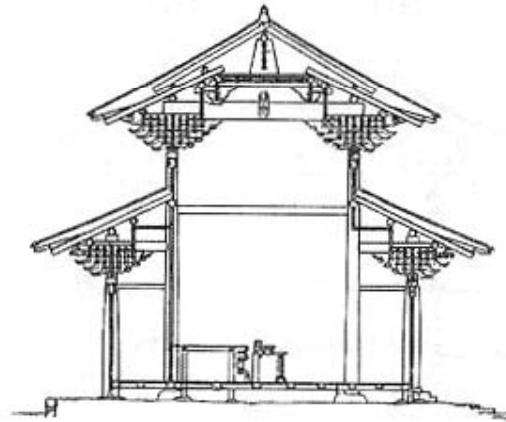

무량사 극락전

중층가구의 방식

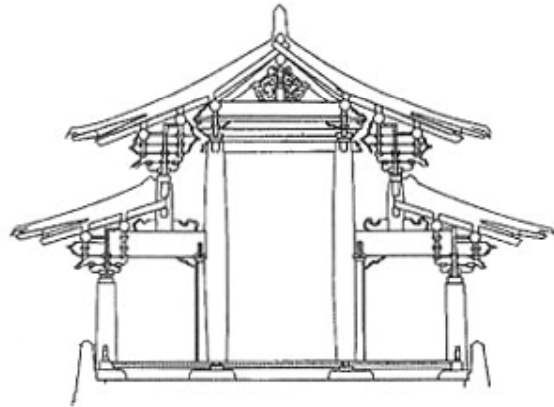

평양 보통문



마곡사 대웅보전

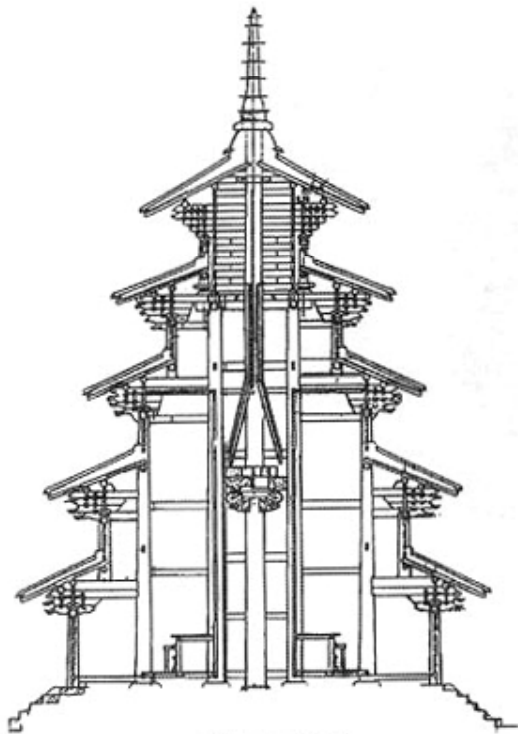

법주사 팔상전

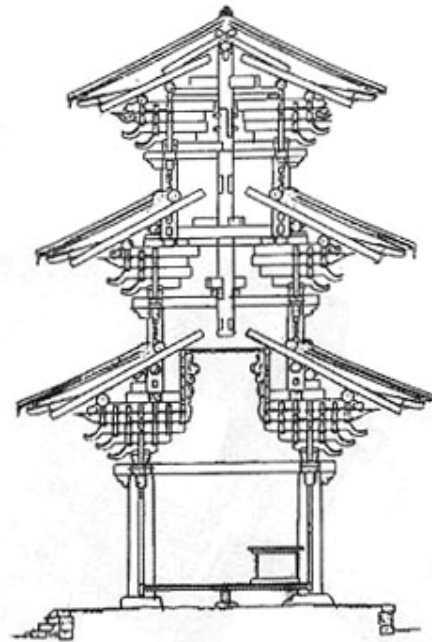

쌍봉사 대웅전

중층가구의 방식

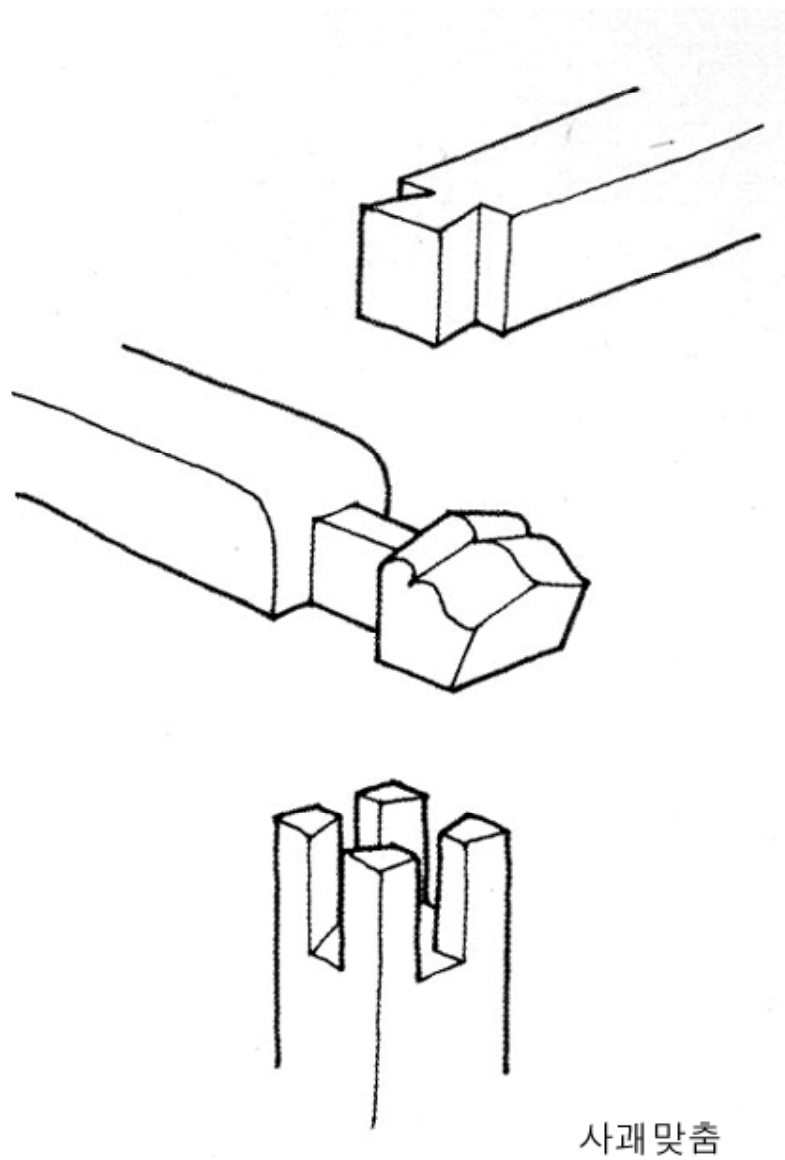
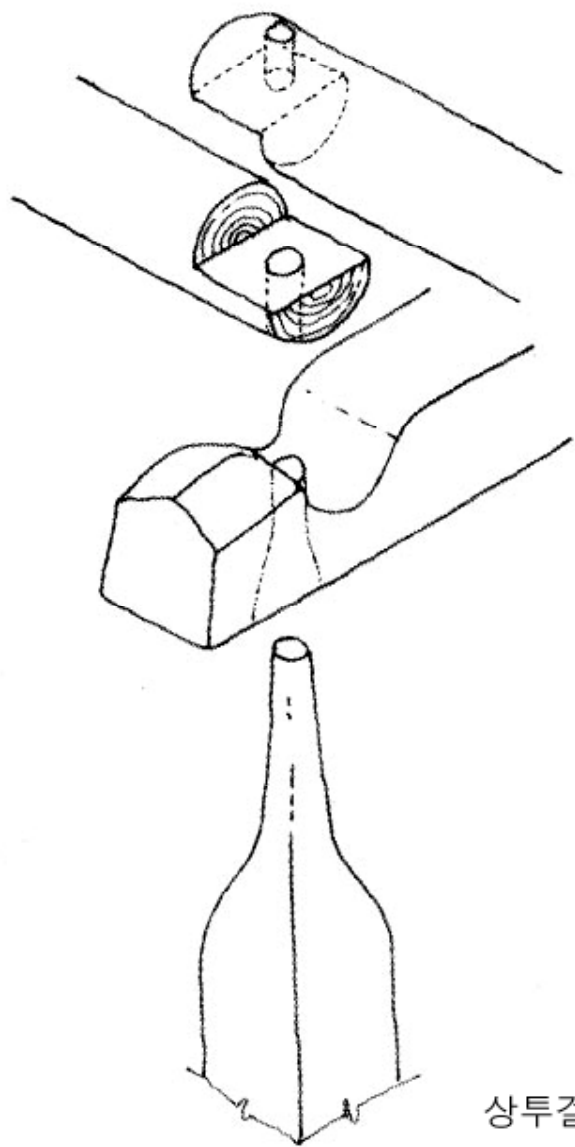

주량작의 분류  
 < 김왕직, 그림으로 보는 한국건축용어 >

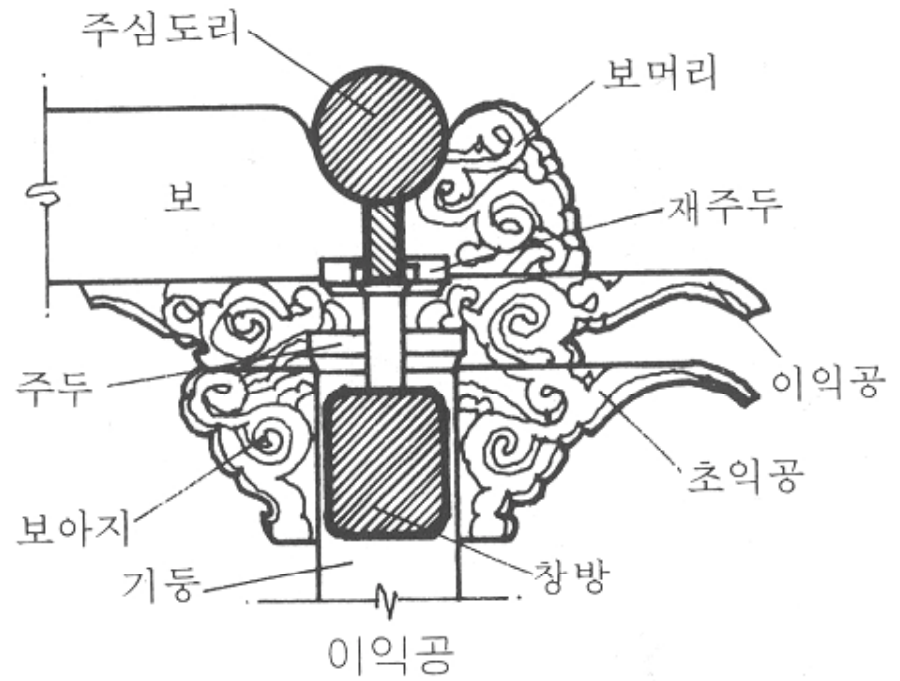
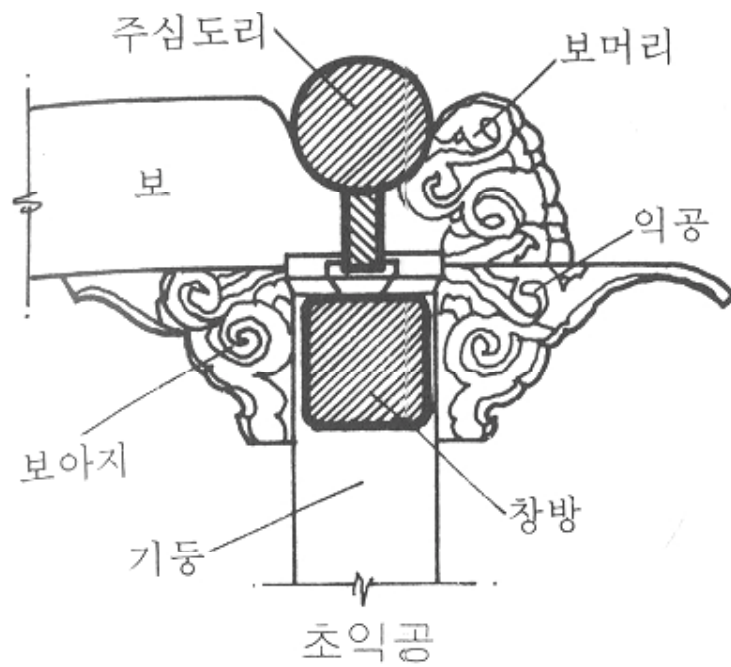

주량작의 분류  
 < 김왕직, 그림으로 보는 한국건축용어 >

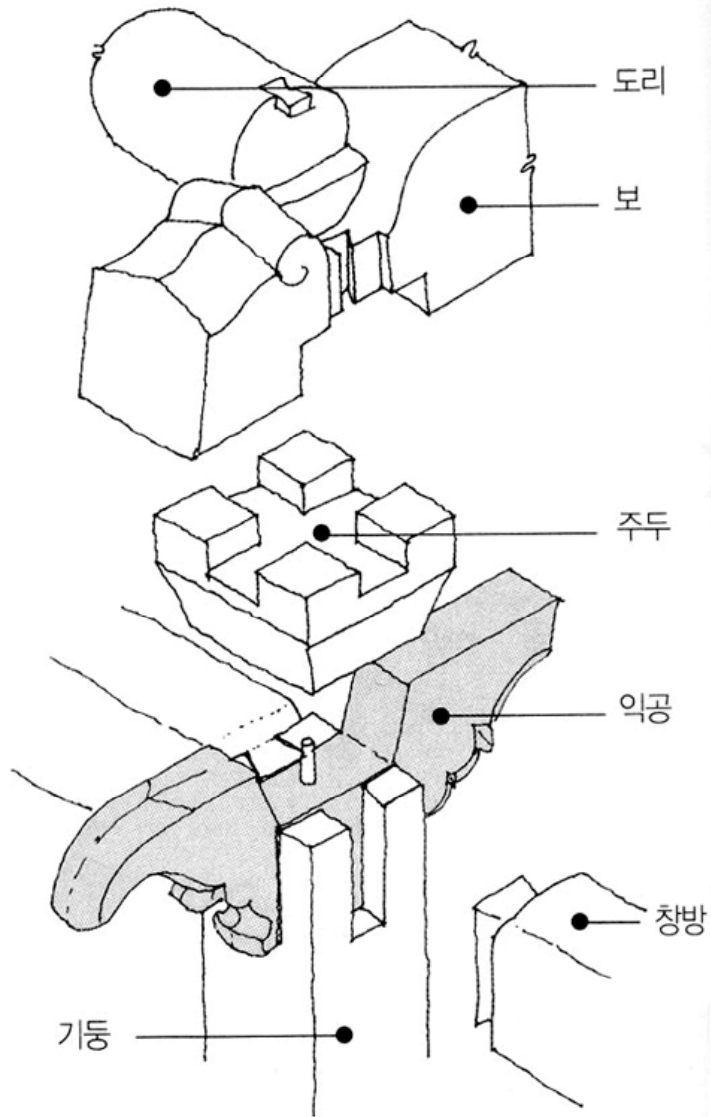

초익공의 짜임  
 < 김왕직, 그림으로 보는 한국건축용어 >

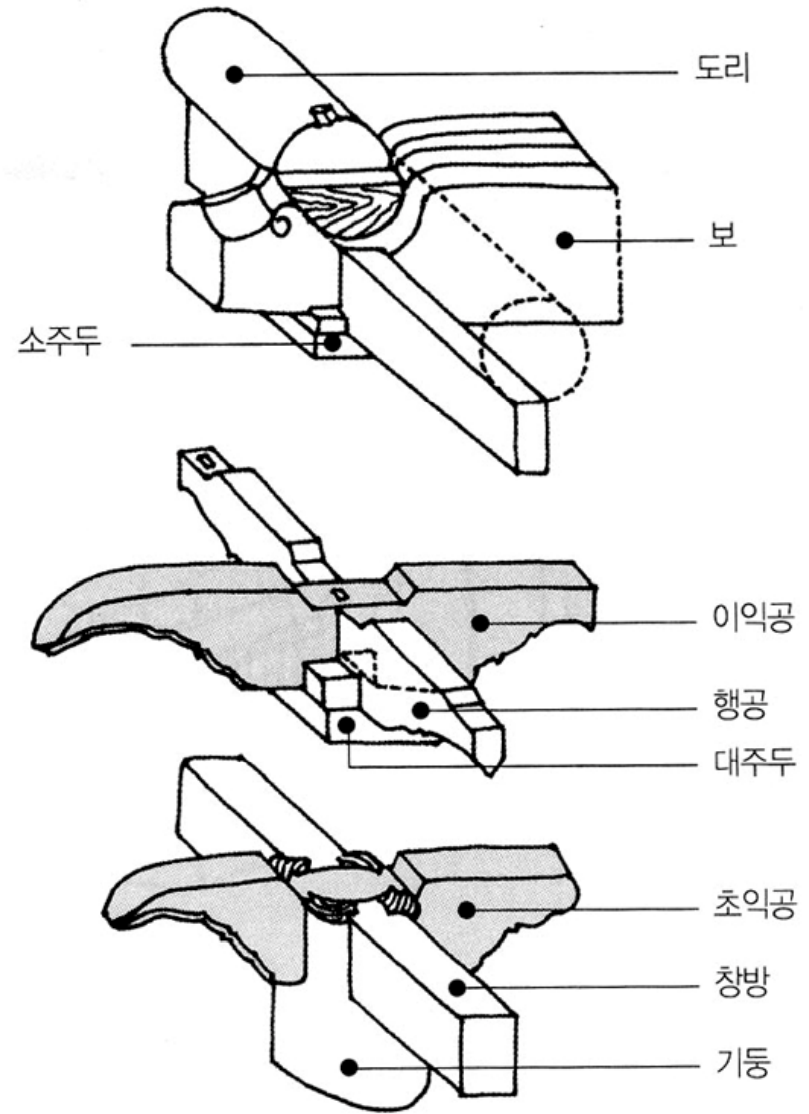

이익공의 짜임  
 < 김왕직, 그림으로 보는 한국건축용어 >



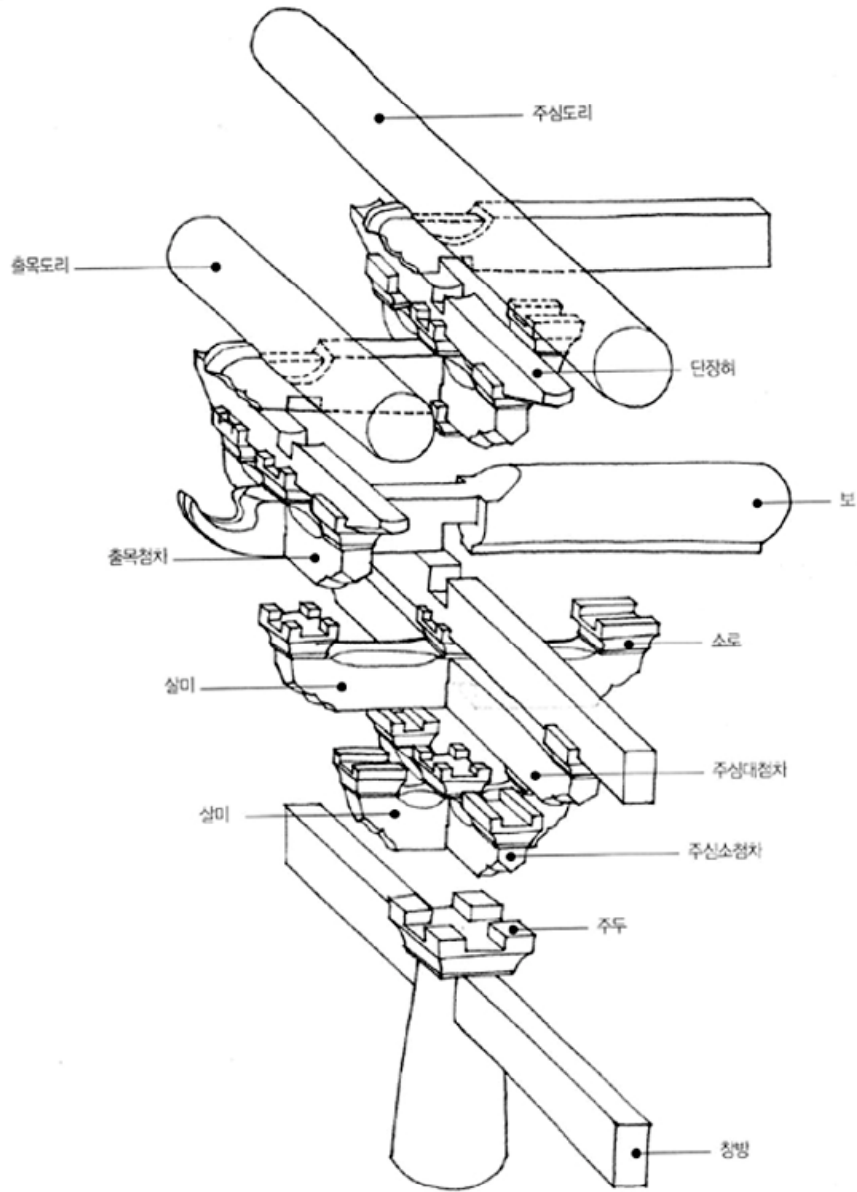

주심포의 짜임  
 < 김왕직, 그림으로 보는 한국건축용어 >

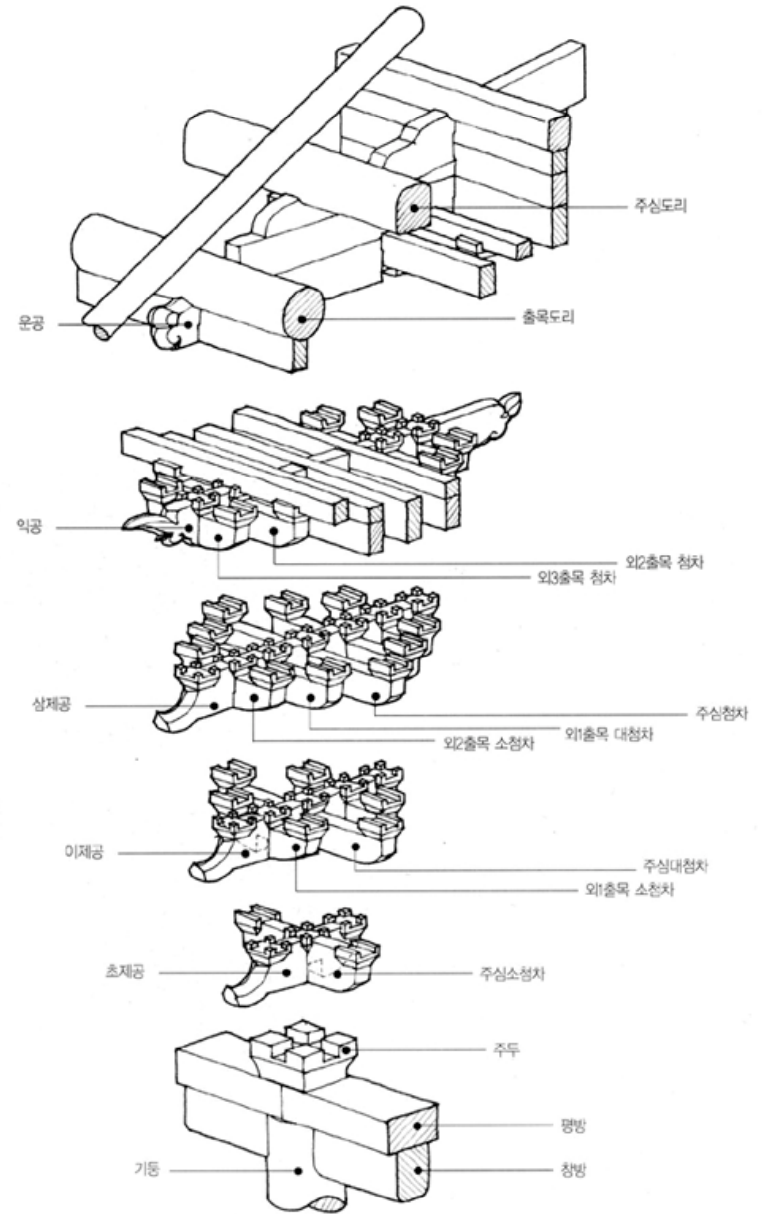

다포의 짜임  
 < 김왕직, 그림으로 보는 한국건축용어 >



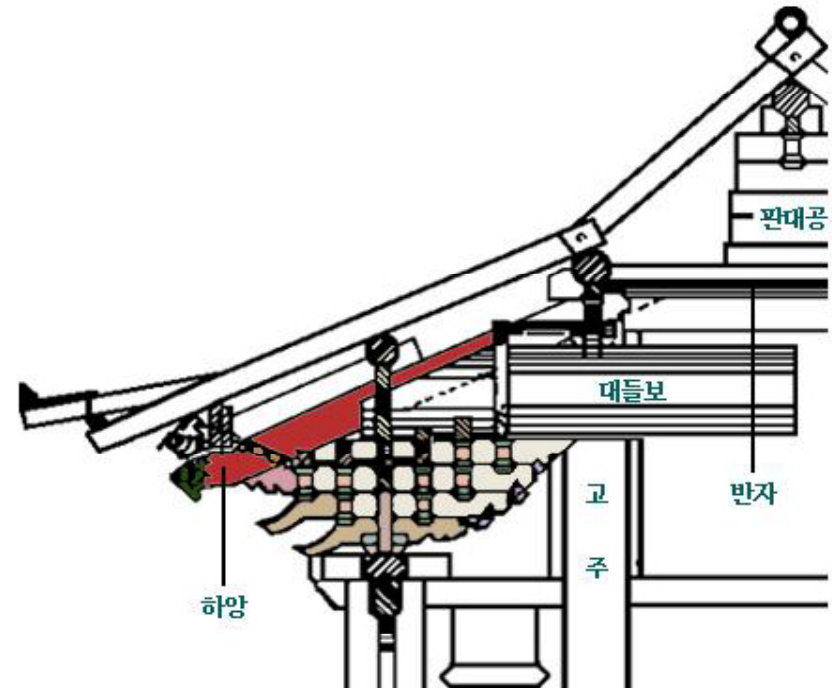
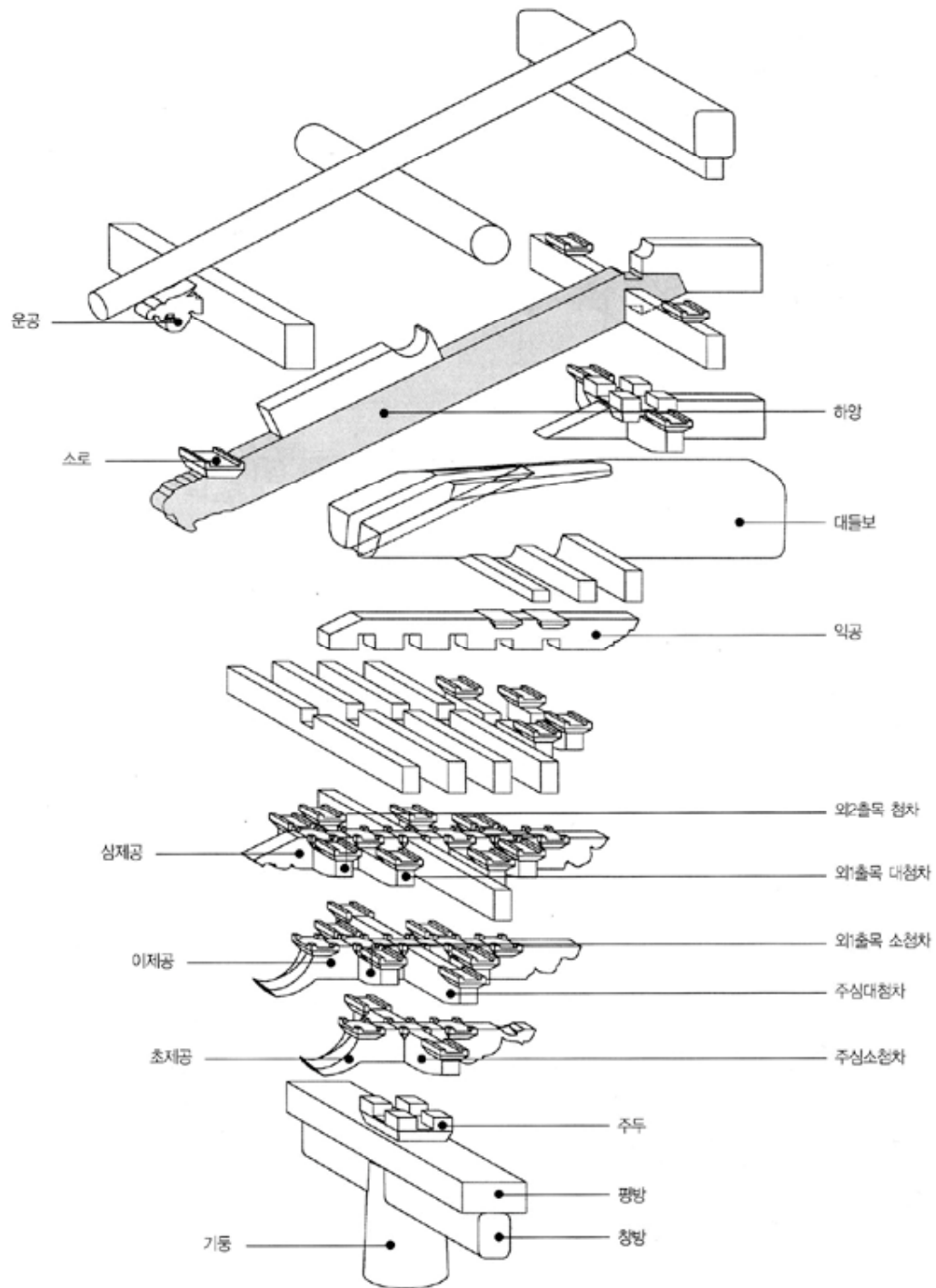

하양식 공포의 짜임  
 < 김왕직, 그림으로 보는 한국건축용어 >

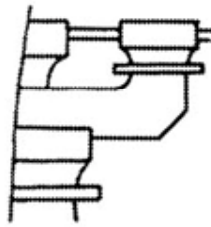

구갑총

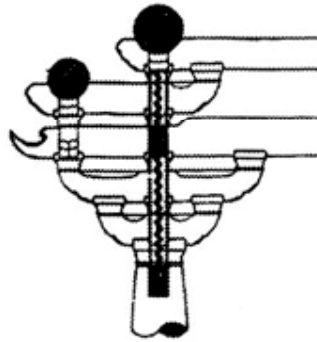

부석사 무량수전

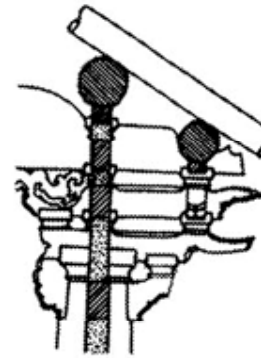

성불사 극락전

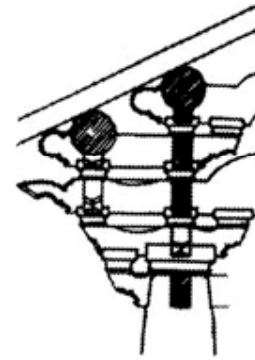

강릉 객사문

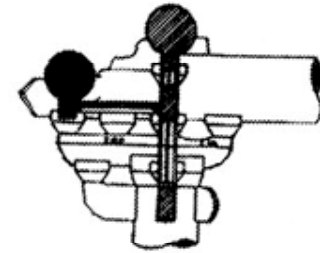

부석사 조사당

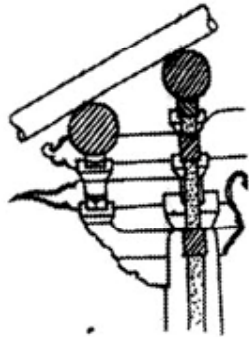

은해사 거조암 영산전

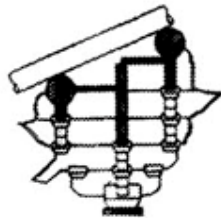

평양 보통문

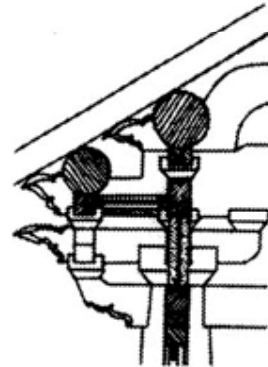

관룡사 약사전

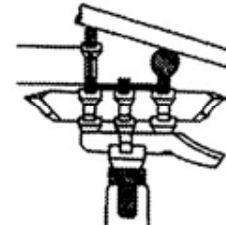

개성 남대문

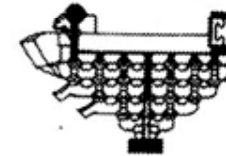

심원사 보광전

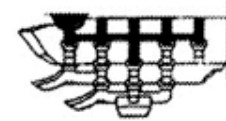

서울 남대문 (하층)

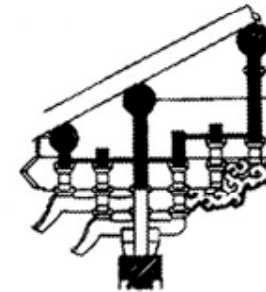

개심사 대웅전

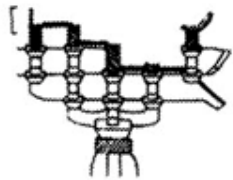

석왕사 응진전

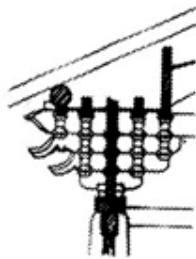

심원사 대웅전

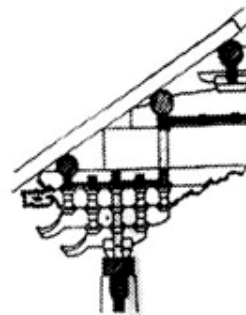

장곡사 하대웅전

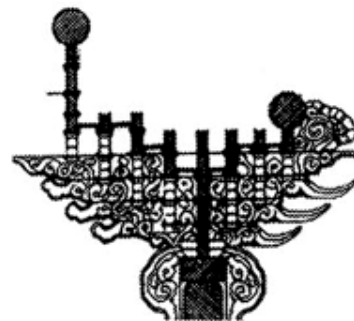

경복궁 근정전

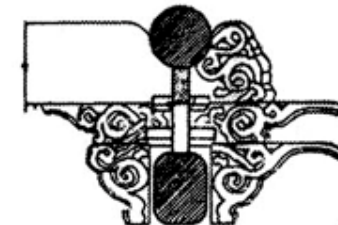

경복궁 경회루

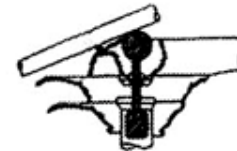

경복궁 교태전

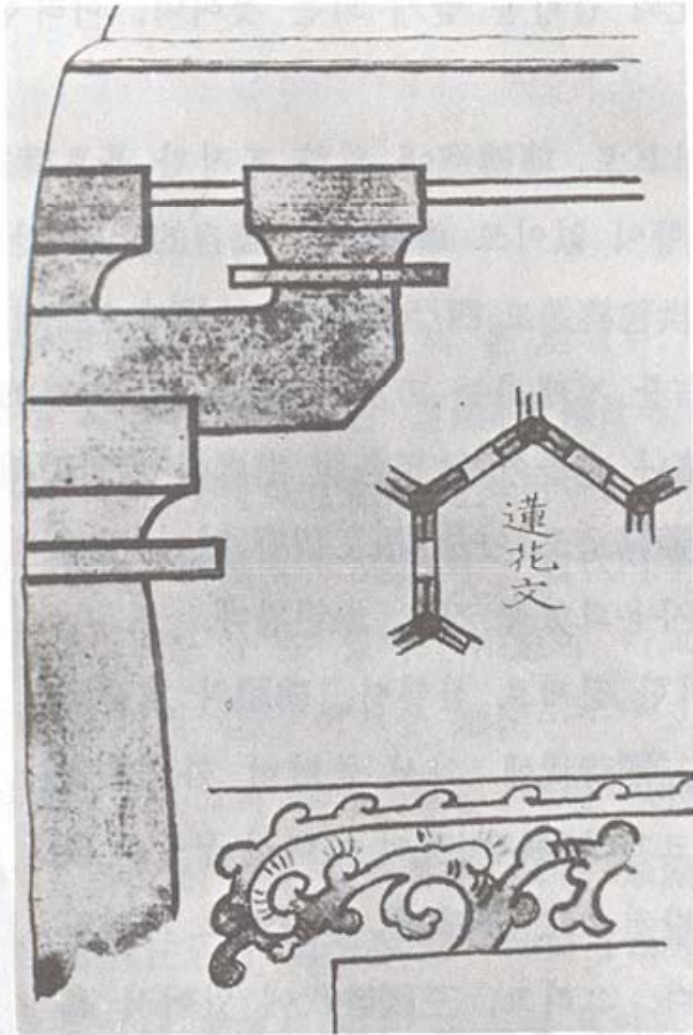

第1·5圖 龜甲塚 玄室壁畫



삼실총



대성리 2호분



성총

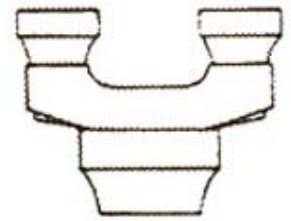

안악 3호분

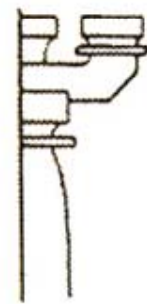

귀갑총

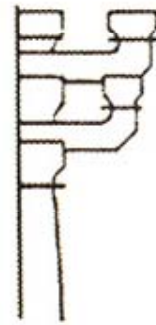

용강대묘

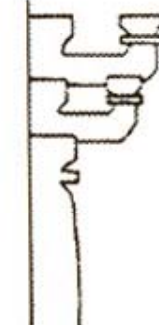

쌍영총

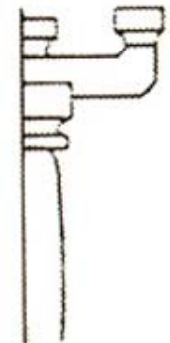

안악 2호분

고구려 고분벽화의 공포  
 < 김동현, 한국 목조건축의 기법 >



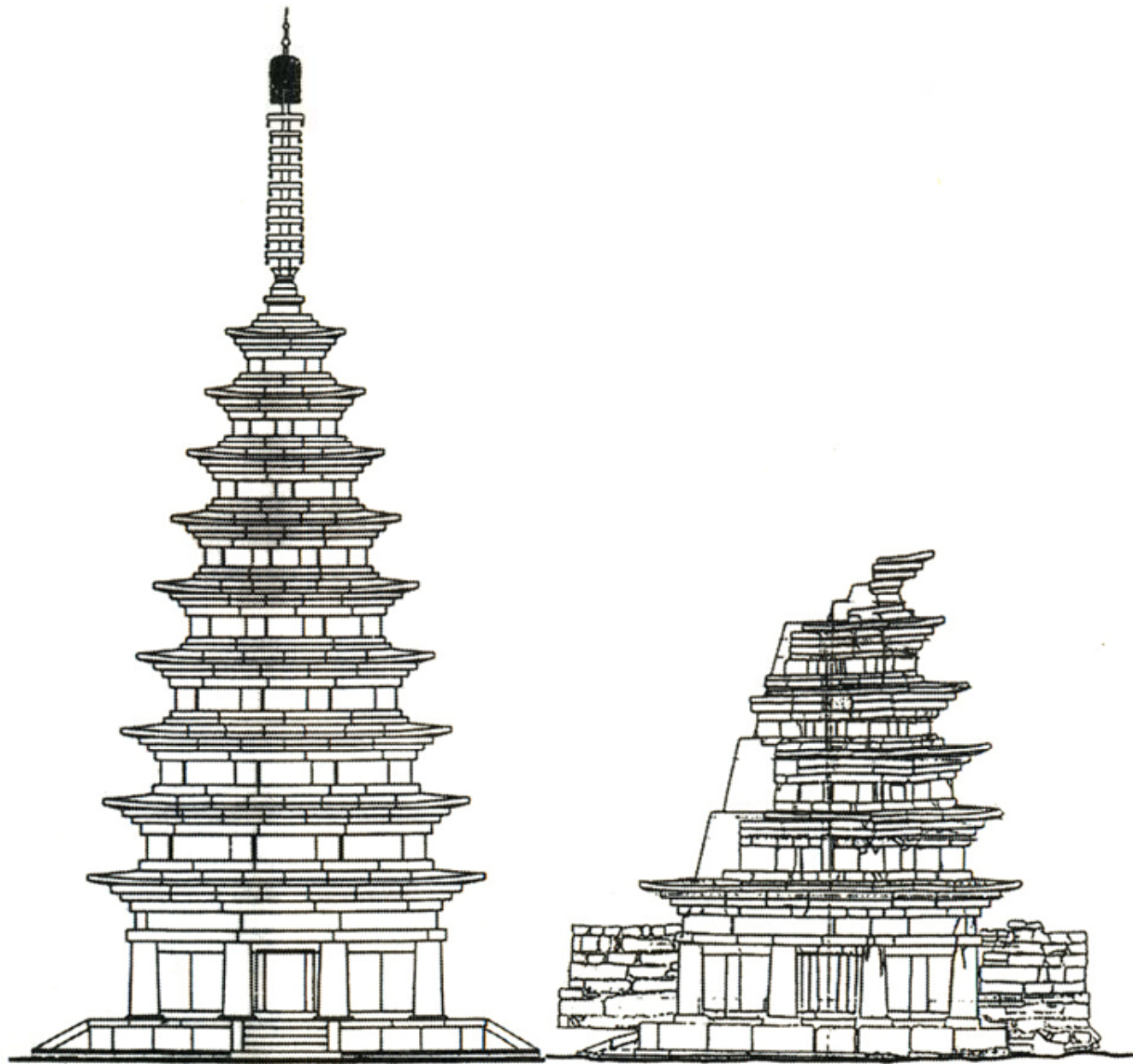

0102045

백제 미륵사지 동탑 및 서탑 복원도  
〈김동현, 한국 목조건축의 기법〉



고려 금동삼존불감  
 < 간송미술관, 국보 73호 >



석남사 부도  
 < 울산 울주군, 통일신라 >



연곡사 동부도  
 < 통일신라 말기, 국보53호 >

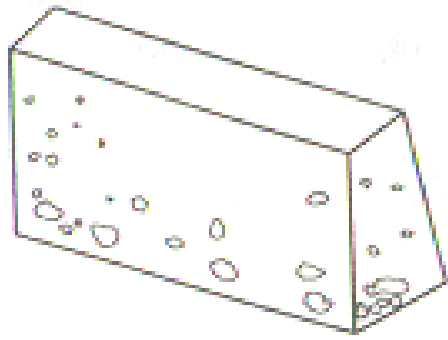

토벽

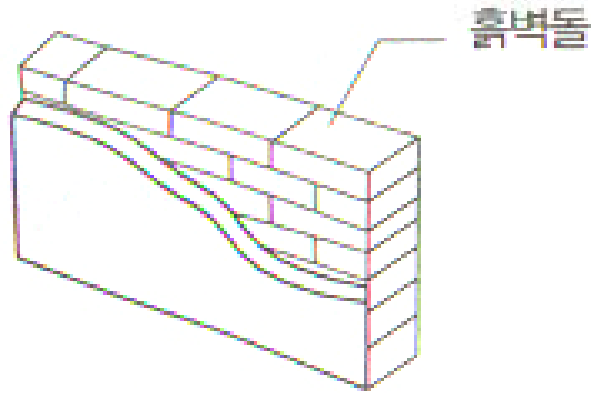

벽돌벽

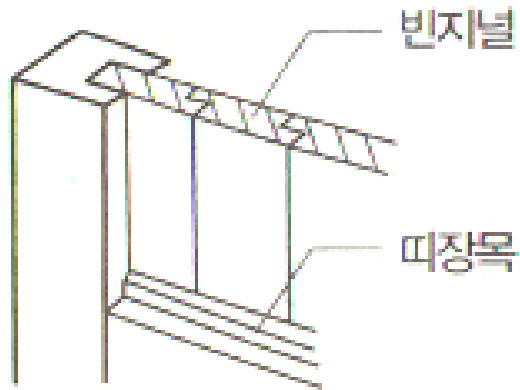

판벽

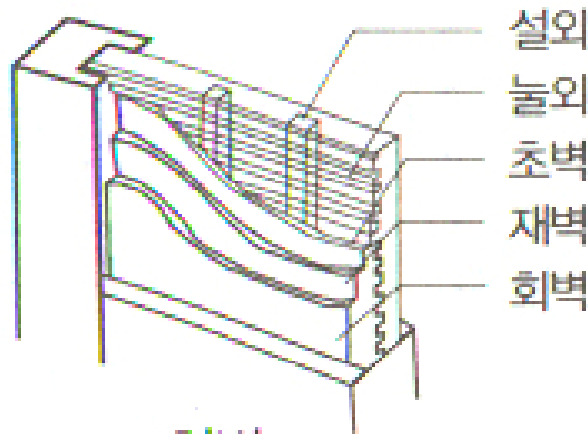

회벽

## 벽의 종류

(한국건축역사학회, 한국건축 답사수첩)



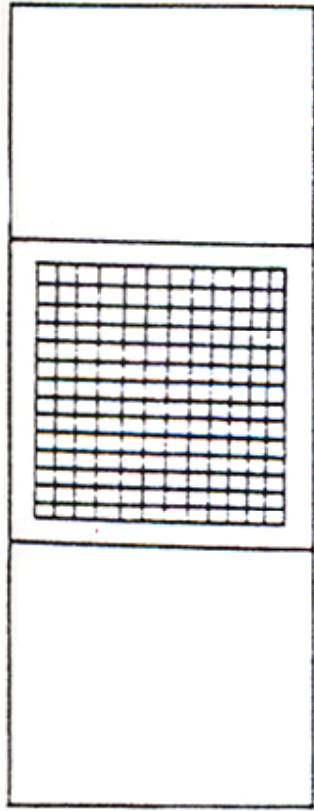

강릉 선교장(船  
橋莊) 의성 김  
씨(義城金氏)  
작은종가 등

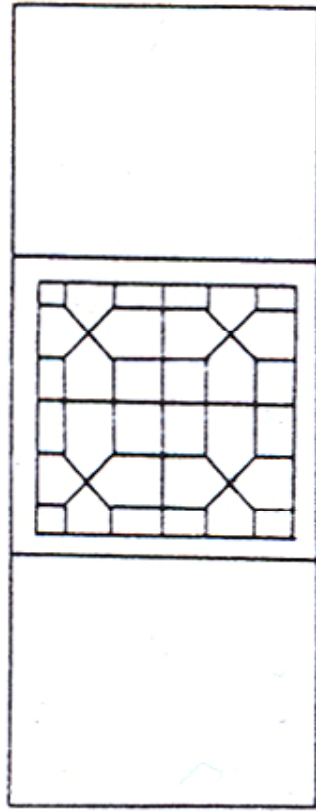

밀양 영남루(嶺  
南樓)

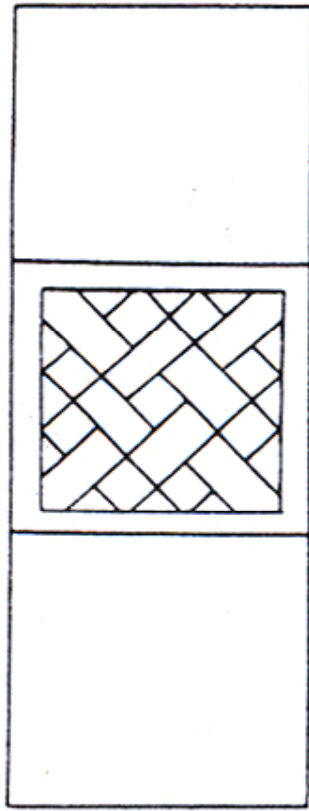

무주(茂州)  
구천동(九千洞)

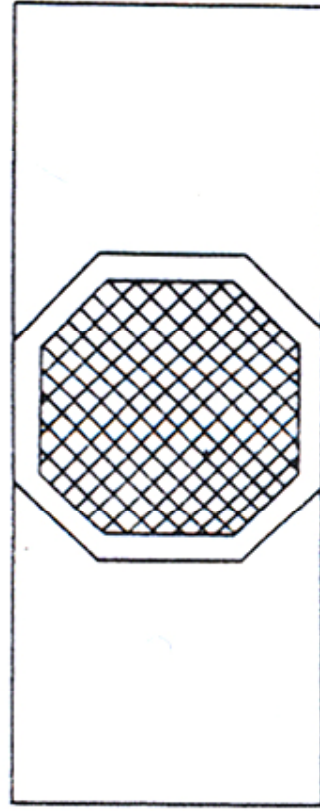

후원(後苑)  
연경당(演慶堂)  
외 다수

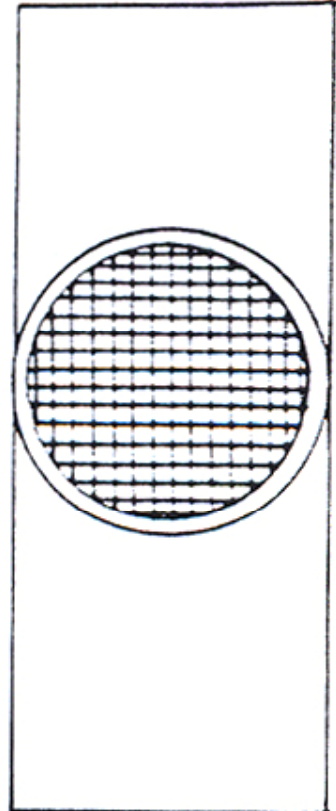

부용정(芙蓉亭)

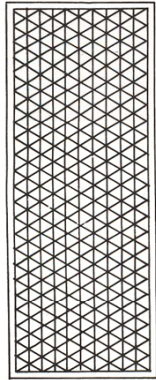

고고 용어집(考古用語集), 신영훈·김동현 고건축단장(20)-창-삼도 37

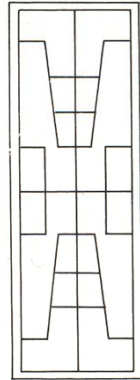

주택의 불방기, 고창(윤오영(尹五榮) 고증)

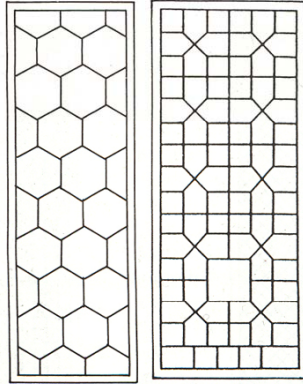

귀갑살

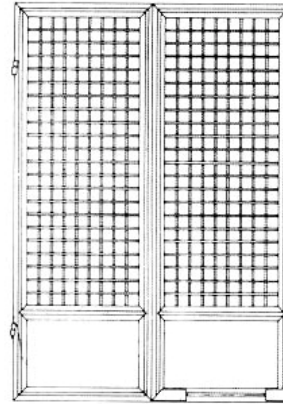

녁살문

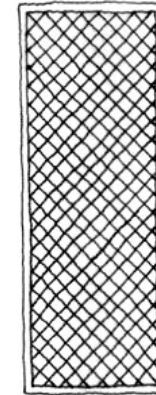

빗살문

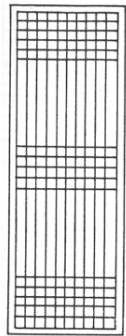

●순천 송광사(松廣寺) 국사전(國師殿)(조선 초기)  
●강릉 오죽헌(烏竹軒)(조선 초기)  
●일반 주택, 사찰, 왕궁 외다수 사용

세살

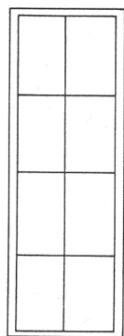

●경북 안동군 하회(河回) 충효당(忠孝堂)  
●예천군 권씨 가옥(조선 중기)

용자(用字)살

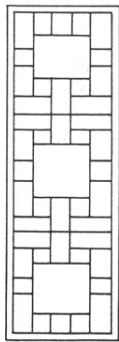
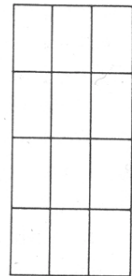

●일반 주택, 왕궁의 내전(內殿), 사찰의 승방, 서원 등

아자살

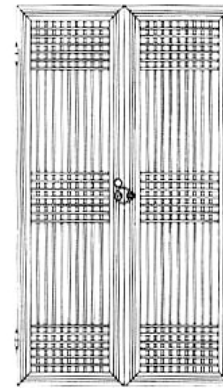
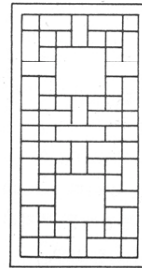

세살문

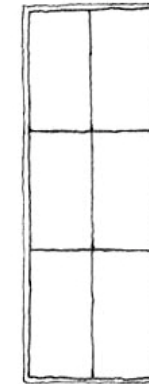

용자살문

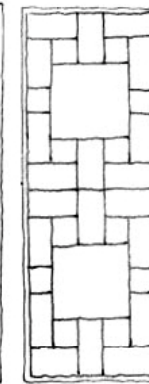

완자살문

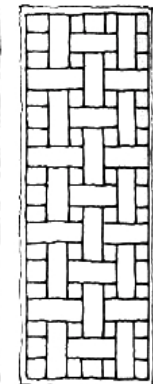

숫대살문

문살의 종류  
< 김왕직, 그림으로 보는 한국건축용어 >

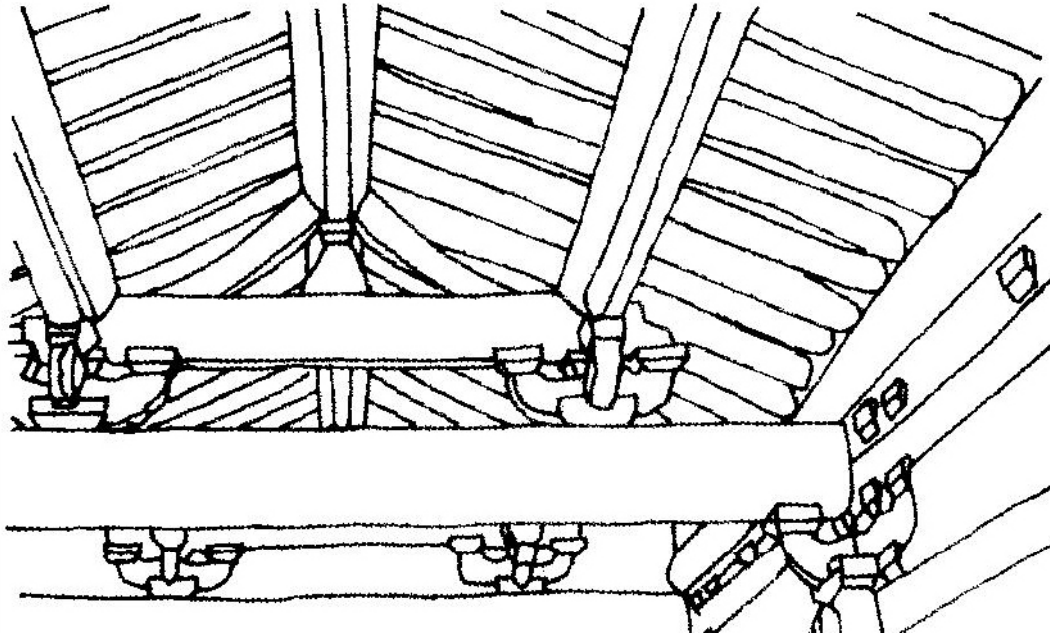

연등천장

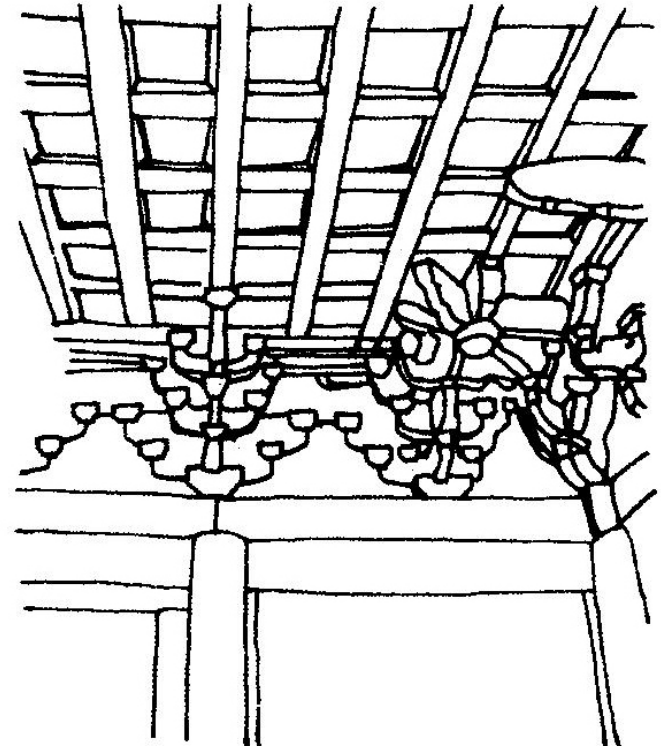

우물천장

### 천장의 종류

(김왕직, 그림으로 보는 한국 건축 용어)



팔작지붕



맞배지붕



우진각지붕



사모지붕



십자형지붕



육모지붕

지붕의 종류



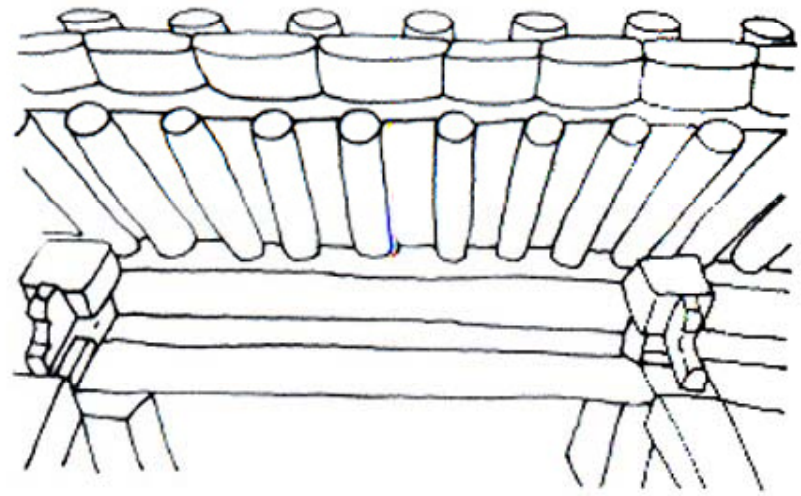
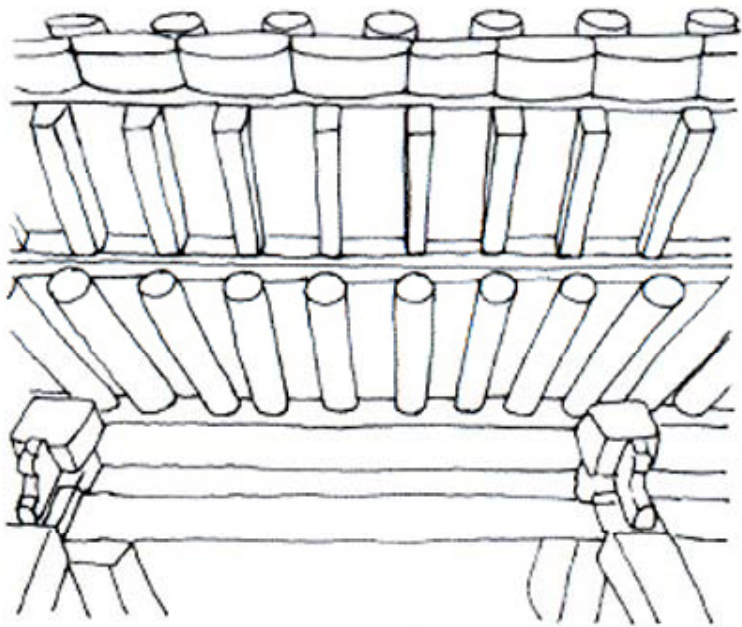

겹처마와 훌처마  
< 김왕직, 그림으로 보는 한국건축용어 >

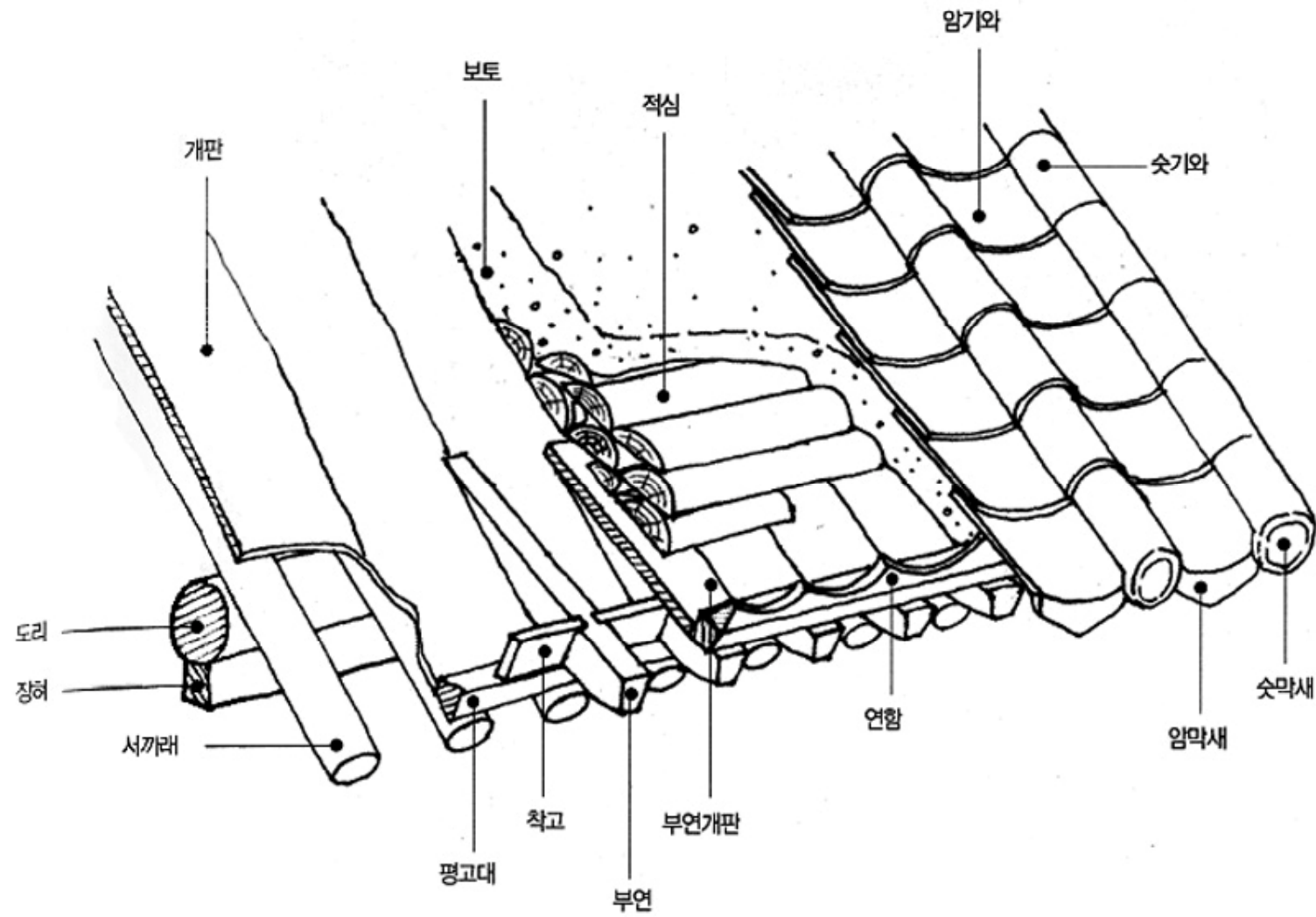

지붕 가구의 구조  
 < 김왕직, 그림으로 보는 한국건축용어 >



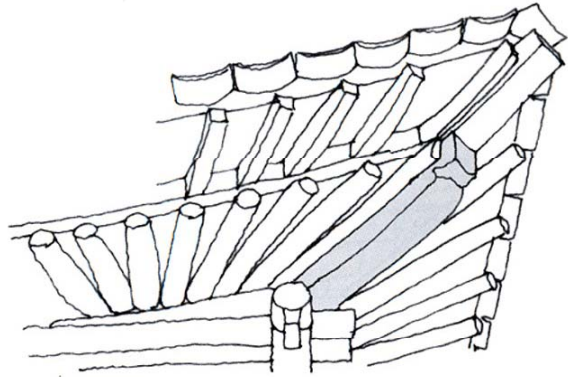

추녀와 사래  
 < 김왕직, 그림으로 보는 한국건축용어 >

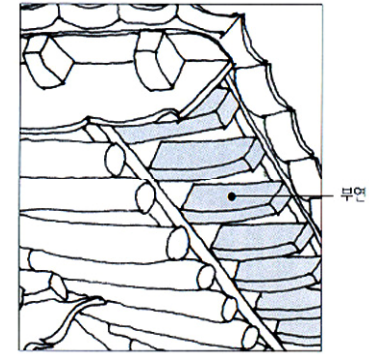
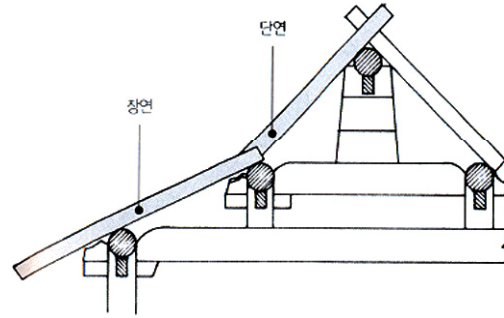

지붕하부부재  
 < 김왕직, 그림으로 보는 한국건축용어 >

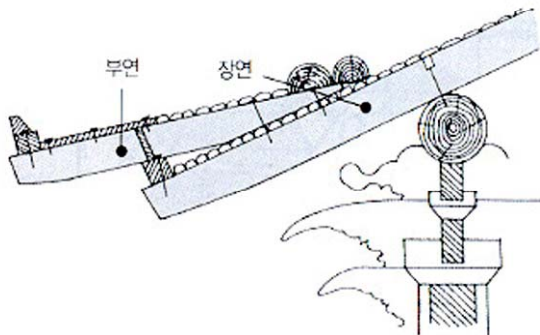

부연과 장연  
 < 김왕직, 그림으로 보는 한국건축용어 >

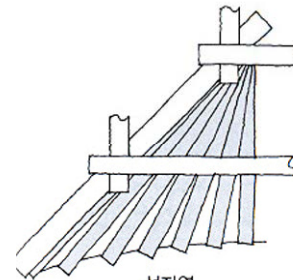

선자연

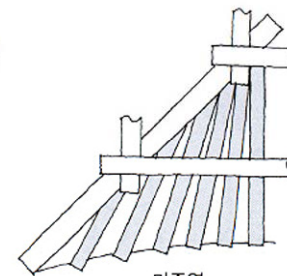

마죽연

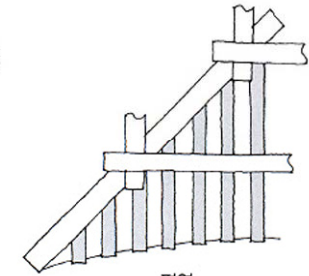

평연

선자연 마죽연 평연  
 < 김왕직, 그림으로 보는 한국건축용어 >

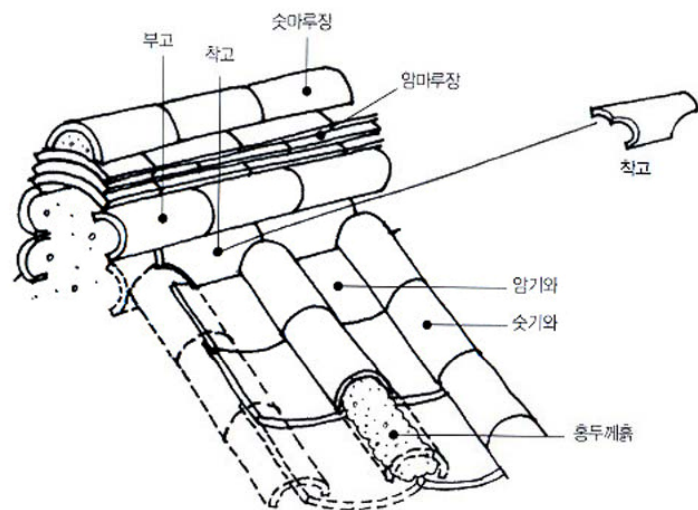

신라

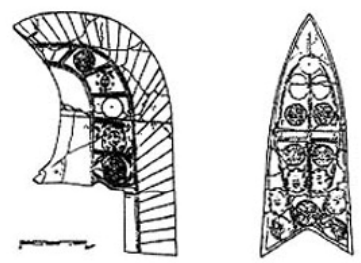

고구려

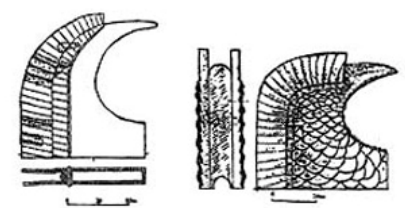

발해

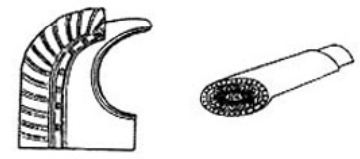

타원형 숯막새(회침 막새)



암막새



모서리기와



금세기와



박공막새

기와  
 < 김왕직, 그림으로 보는 한국건축용어 >

각종 기와  
 < 김왕직, 그림으로 보는 한국건축용어 >

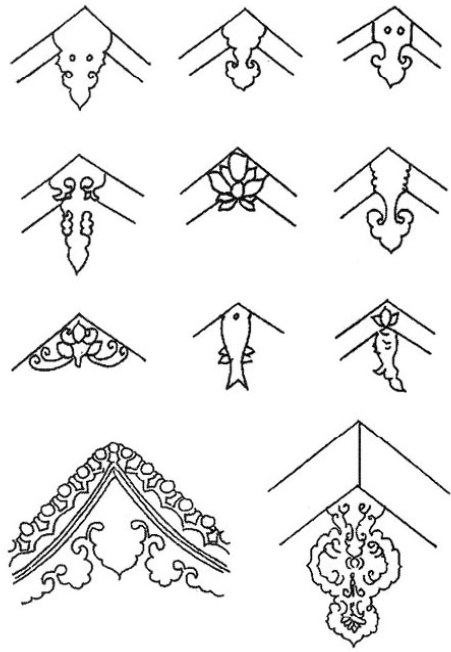

瓦像圖

像瓦圖



大唐騎夫



孫行者



豬八戒



獅畫像



二鬼朴



二口龍



馬畫像



三教菩薩



穿山甲

집상



우물마루

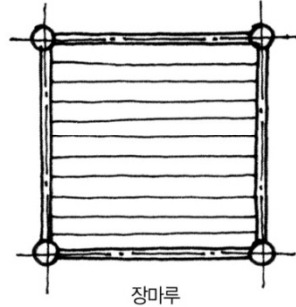

장마루

우물마루, 장마루

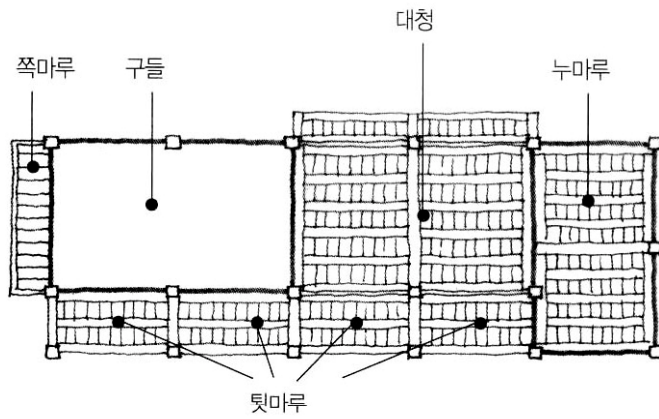

마루의 명칭

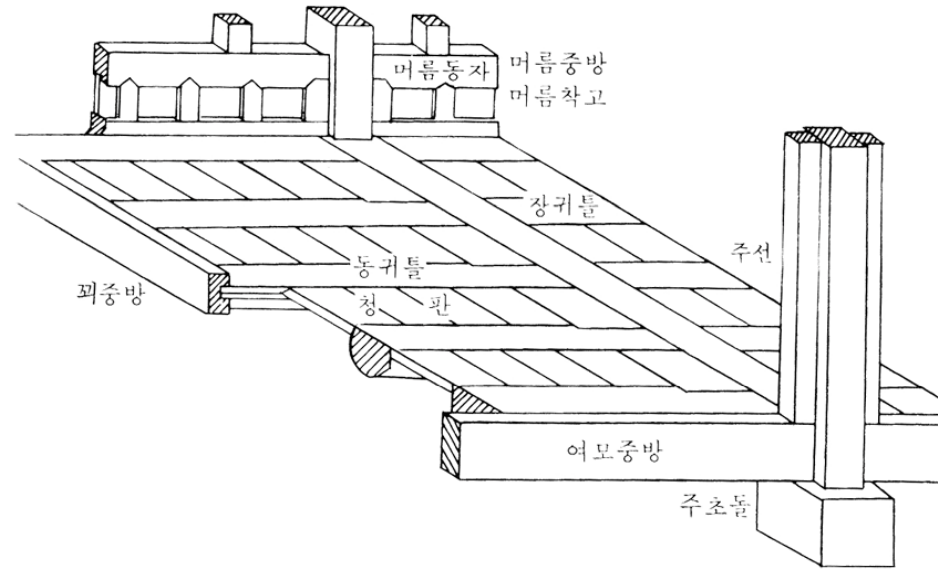

우물마루의 구조

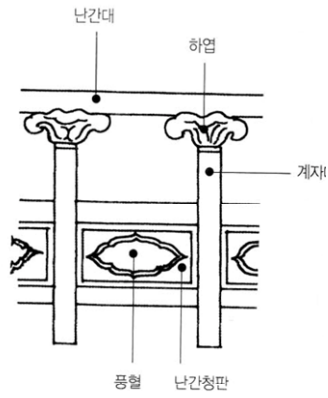
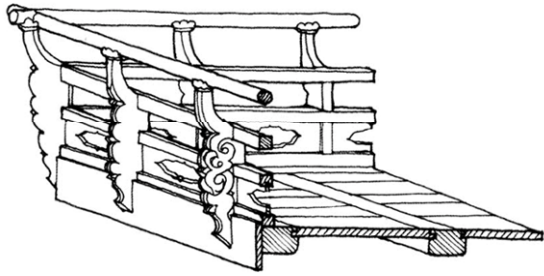

난간-계자각

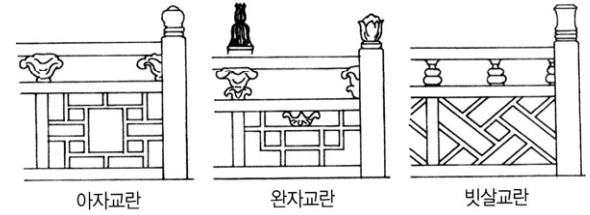
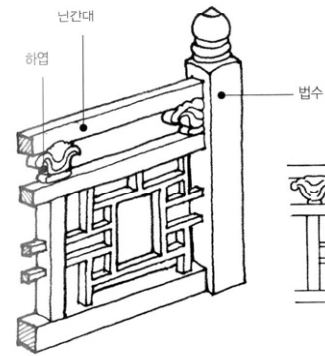

난간-평난간



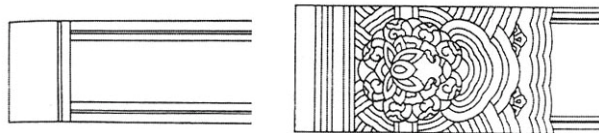

꺾기단청



모루단청

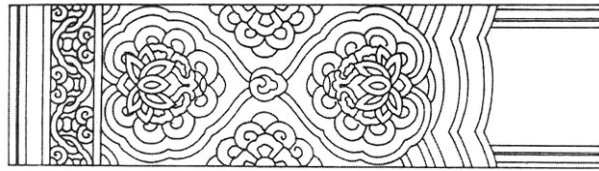

선모루단청

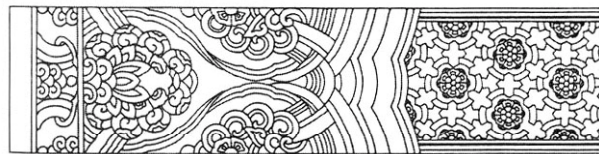

선단청

단청의 종류

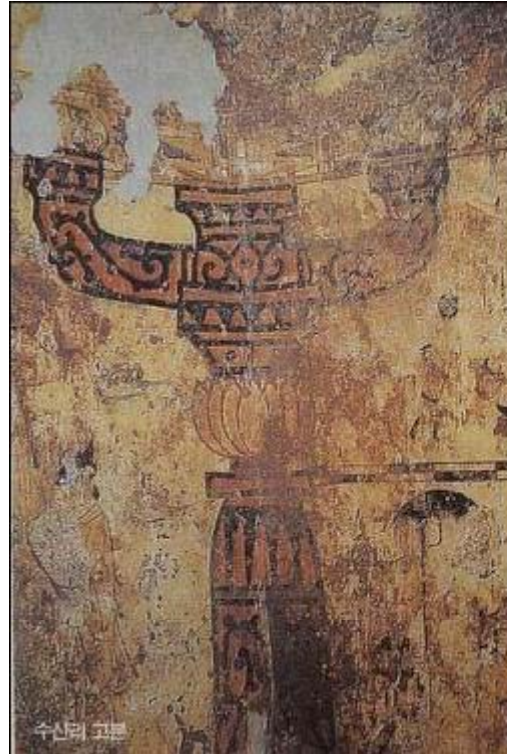

수산리 고분



인악 2호분





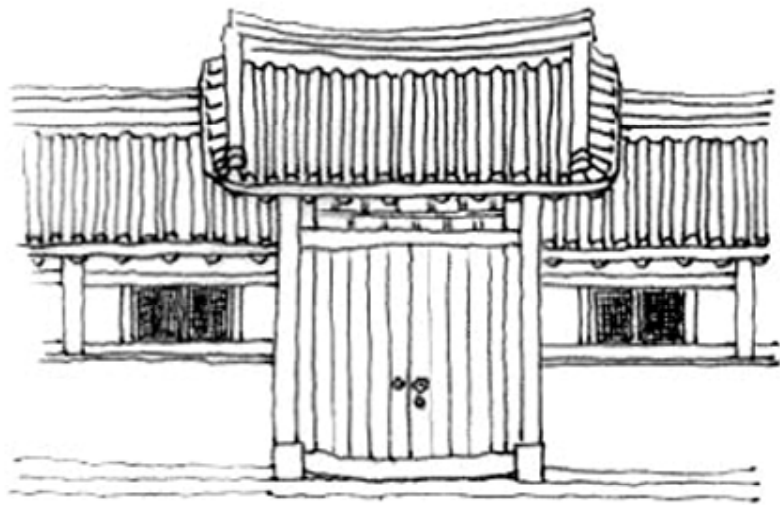

shotel-daemun

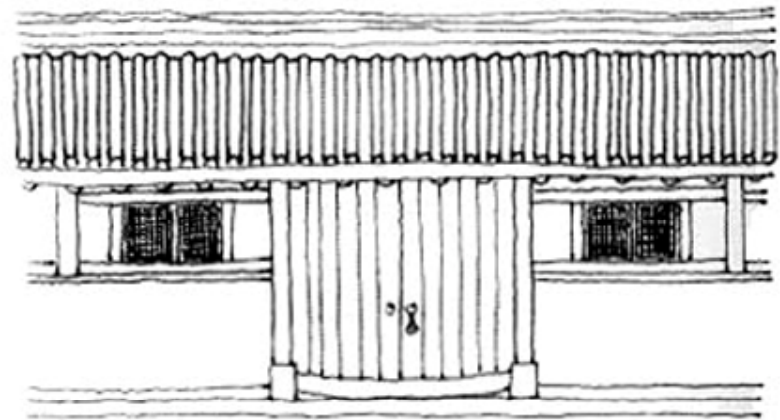

pyeong-daemun

shotel daemun and pyeongdaemun  
<Kim Wang-jik, drawing of Korean architecture>

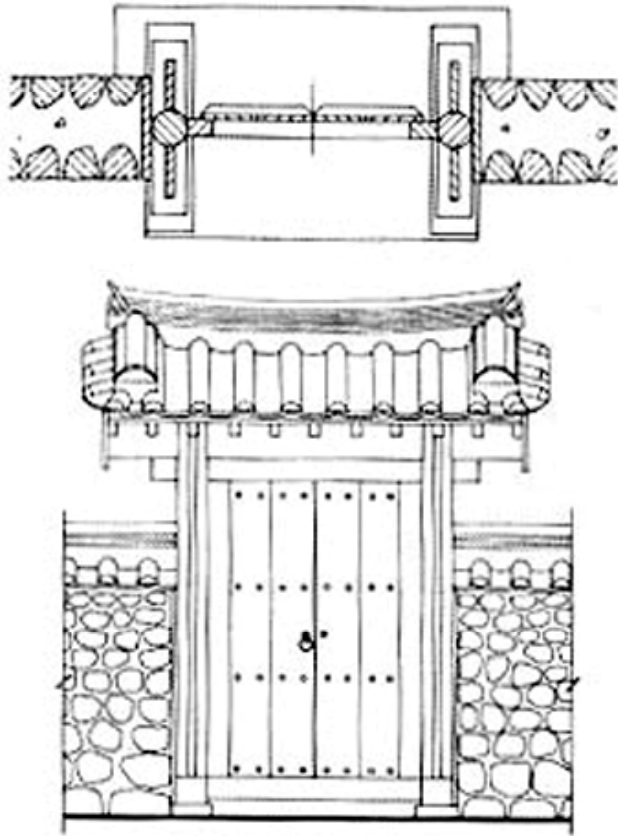

한문  
<김왕직, 그림으로 보는 한국건축용어>

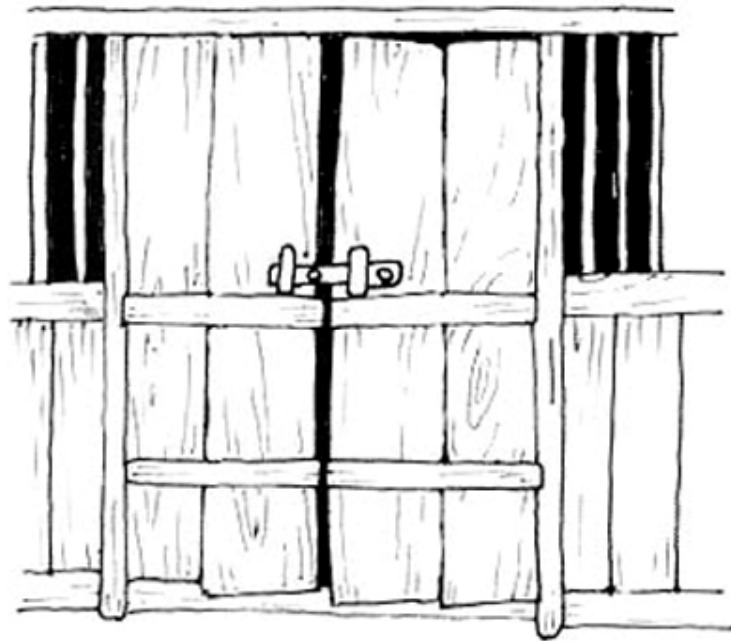

판문

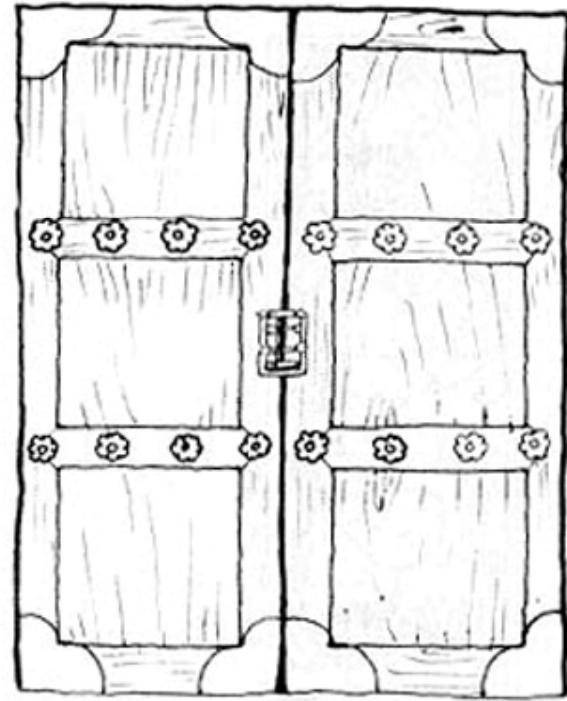

당판문

판문  
〈김왕직, 그림으로 보는 한국건축용어〉